



50 Marlbrook Lane, Marlbrook
Bromsgrove

£575,000



A neatly presented four-bedroom detached family home, situated in the highly sought-after Marlbrook area of Bromsgrove. Offering spacious and versatile accommodation arranged over two floors, this impressive property is further enhanced by an open-plan kitchen/diner/family room, generous lounge, manicured rear garden, integral double garage, and driveway parking, making it ideal for modern family living. The property is perfectly positioned for easy access to well-regarded local schools, shops, and excellent transport and motorway links.

Upon entering the welcoming hallway, you are led into a spacious lounge, an ideal space for relaxing, fitted with oak flooring. From here, double doors open into the stunning open-plan kitchen/dining/family area, creating a superb sociable hub of the home with bi-folding doors overlooking and opening onto the garden. The kitchen is fitted with a central breakfast island and a range of integrated appliances, including two cookers, warming drawer, dishwasher, induction hob, and wine fridge. A defined dining/snug area completes this versatile space. Adjacent to the kitchen is a separate utility room, providing additional practical laundry space with direct external access to the rear garden. The hallway and WC are finished with Karndean flooring throughout.

Also on the ground floor is a dedicated office, a convenient WC, and internal access to the double garage, along with useful under-stairs storage.

To the first floor, the landing provides access to four bedrooms. The master bedroom benefits from its own en-suite shower room, while bedrooms two, three, and four are served by a family bathroom. Bedroom four is currently utilised as a dressing room.

Externally, the property enjoys a beautifully maintained and manicured rear garden, providing a wonderful outdoor space for dining, entertaining, or family relaxation. The garden features an initial paved patio area housing a hot tub (available by separate negotiation), steps leading up to a decked seating area, and a lawned garden, all enclosed by fenced boundaries for privacy.

Located in the desirable residential area of Marlbrook, Bromsgrove, Marlbrook Lane offers a peaceful setting while remaining conveniently close to a range of local amenities, schools, and transport links. The location provides excellent access to Bromsgrove town centre, as well as surrounding countryside, making it ideal for those seeking a balance of suburban living with nearby rural walks and commuter convenience.

Disclaimer

These particulars are for guidance only and based on information approved by the seller. Accuracy cannot be guaranteed and details may contain errors or omissions. They do not form part of any contract. We are not surveyors or legal experts and cannot advise on condition, title, or other legal matters. Buyers should instruct their own professionals before making decisions. Photos are illustrative only and items shown are not necessarily included. Fixtures, fittings and appliances are not tested and may not be in working order. All measurements are approximate. No liability is accepted for loss from use of these details.

By law we must carry out ID and AML checks and review buyers' financial circumstances before a property can be marketed subject to contract. This due diligence is required by trading standards. Checks start once a provisional offer is agreed. The cost is £30 incl. VAT per property, payable in advance via our onboarding system.



Marlbrook Lane, Bromsgrove

Ground Floor

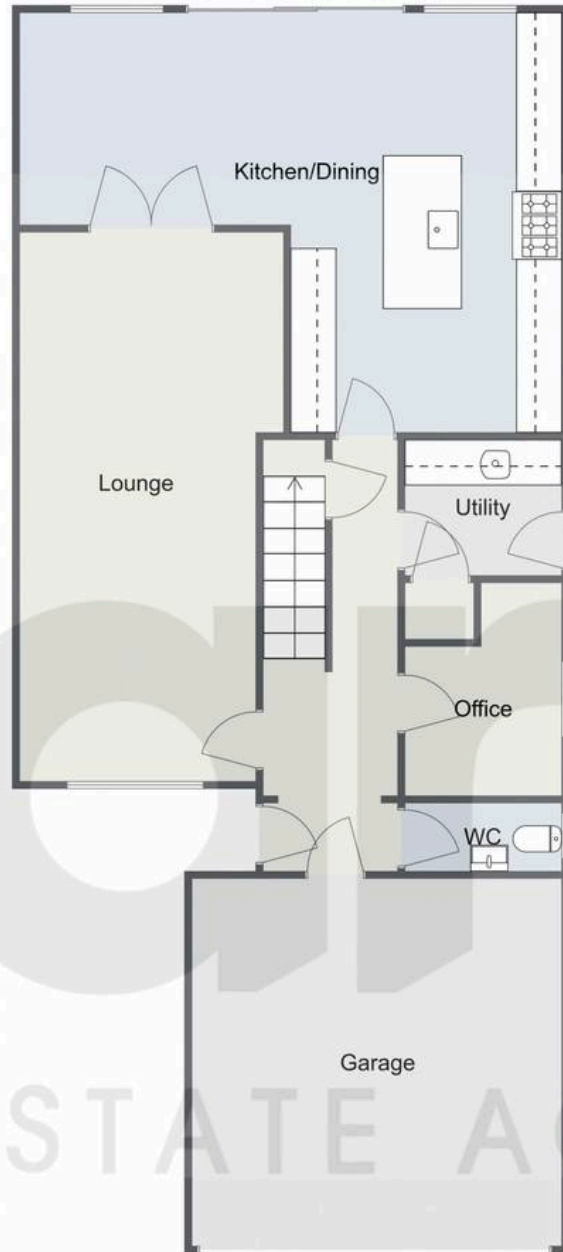

First Floor



Total Area Approx
153.1 Sq M
1647.95 Sq Ft
(including Garage)

ESTATE AGENTS

For illustrative purposes only. Decorative finishes, fixtures & fittings do not represent the current state of the property. Measurements are approximate & not to scale. Floor Plans made using RoomSketcher.



Arden Estates Bromsgrove

Arden Estates Bromsgrove, 14 Old Birmingham Road, Lickey End -
B60 1DE

01527 872 479

bromsgrove@ardenestates.co.uk

ardenestates.co.uk/contact-us/bromsgrove/