

96 Taylor Road, Birmingham

Birmingham

Offers in Region of £350,000

96 Taylor Road

Birmingham, Birmingham

A beautifully presented and extended three-bedroom mid-terrace home in a popular location, featuring a spacious through lounge, modern fitted kitchen, south-facing garden and driveway parking. Council Tax band: B

Tenure: Freehold

EPC Energy Efficiency Rating: D

EPC Environmental Impact Rating: D

- Beautifully presented and extended three-bedroom mid-terrace home
- Spacious through lounge and dining area
- Modern fitted kitchen with garden access
- Contemporary family bathroom
- Pleasant south-facing rear garden with patio and lawn
- Driveway providing off-road parking
- Popular and convenient location near Kings Heath, Moseley, and local amenities
- Excellent transport links via the A435 Alcester Road South and Haunch Lane
- Ideal home for families or first-time buyers
- Three Good Sized Bedrooms





You can include any text here. The text can be modified upon generating your brochure.



Taylor Road, Birmingham

Ground Floor

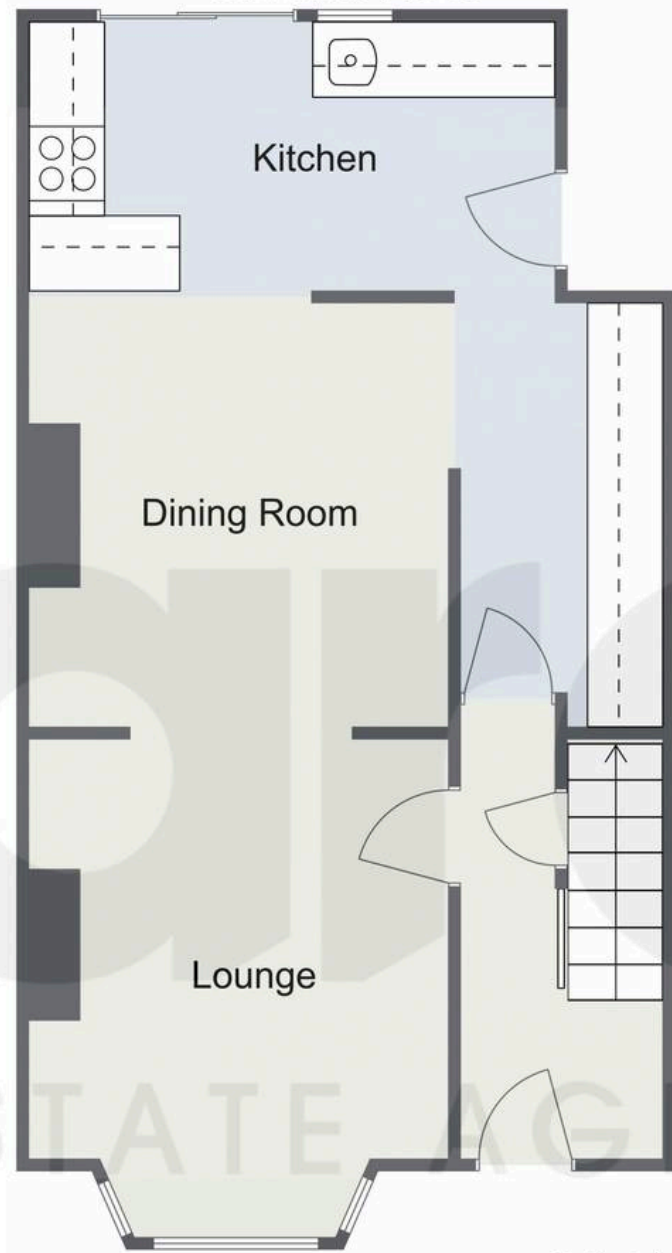

First Floor

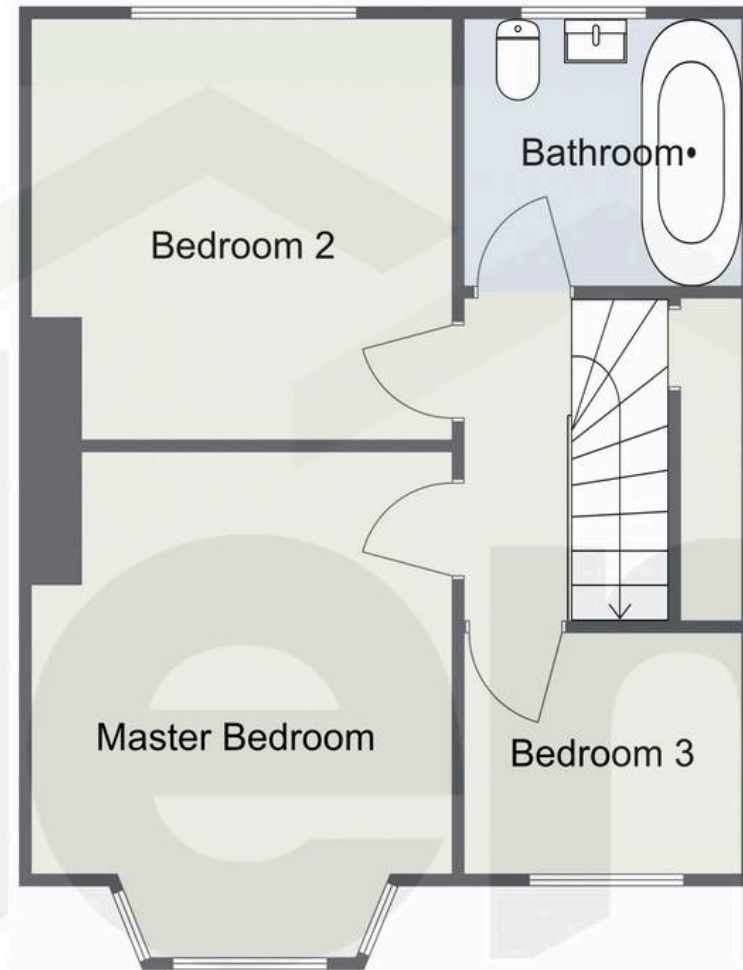

Total Area Approx
82.9 Sq M
892.32 Sq Ft

For illustrative purposes only. Decorative finishes, fixtures & fittings do not represent the current state of the property. Measurements are approximate & not to scale. Floor Plans made using RoomSketcher.



Arden Estates

450 Stratford Road, Solihull - B90 4AQ

0121 745 5888 • solihull@ardenestates.co.uk •