

**Mews 18, 3 Sidbury House College Street**

Worcester

In Excess of **£150,000**



# Mews 18

3 Sidbury House College Street, Worcester

Council Tax band: C

Tenure: Leasehold

EPC Energy Efficiency Rating: C

EPC Environmental Impact Rating: C

- City Centre Living
- Two Bedrooms
- Secured Gated Entrance
- Open Plan Kitchen/Living Space









You can include any text here. The text can be modified upon generating your brochure.



# College Street, Worcester

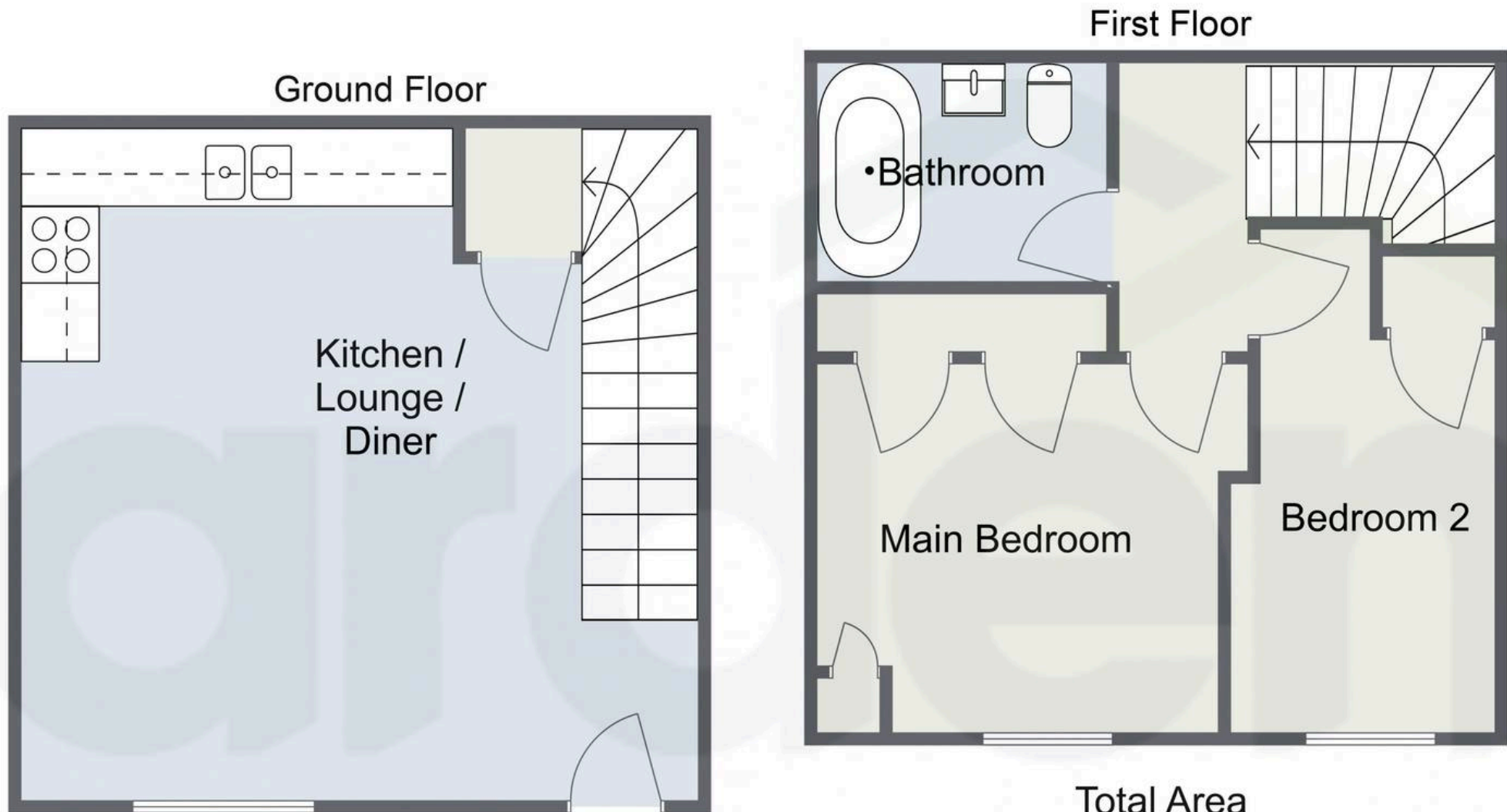

Total Area  
Approx  
53.0 sq m  
570.5 sq ft

For illustrative purposes only. Decorative finishes, fixtures & fittings do not represent the current state of the property. Measurements are approximate & not to scale.  
Floor Plans made using RoomSketcher.





# Arden Estates

Arden Estate Agents, 15 Foregate Street – WR1 1DB

01905 958 290 • [worcester@ardenestates.co.uk](mailto:worcester@ardenestates.co.uk) •