

23 Wharf House Waterside, Shirley

Solihull

In Excess of £270,000

23 Wharf House Waterside

Shirley, Solihull

Large 3-bed apartment with new kitchen, bright feel,
CHAIN FREE sale at Wharf House. Over 1,100 sq ft
Council Tax band: E

Tenure: Leasehold

EPC Energy Efficiency Rating: B

EPC Environmental Impact Rating: B

- No chain
- Three double bedrooms
- Main bedroom with en-suite
- Two modern bathrooms
- Peaceful setting within the Waterside development
- Beautiful views
- Stunning canal side walks right on your doorstep
- Sought After location
- Within close proximity to local amenities
- Ideal for professionals, downsizers, or buy-to-let investors





You can include any text here. The text can be modified upon generating your brochure.



Wharf House, Waterside, Solihull

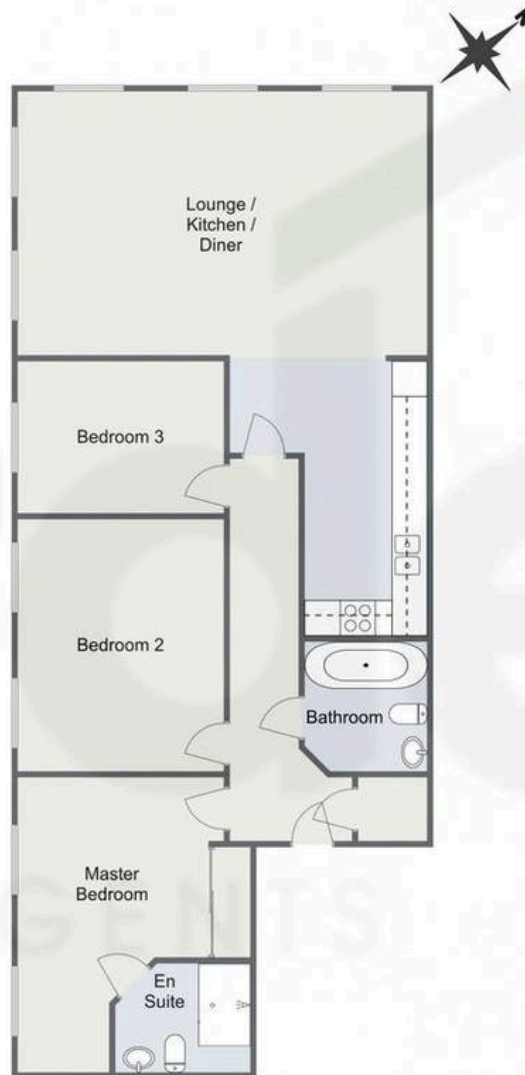

Total Area Approx
104.6 Sq M
1125.9 Sq Ft

For illustrative purposes only. Decorative finishes, fixtures & fittings do not represent the current state of the property. Measurements are approximate & not to scale.
Floor Plans made using RoomSketcher.



Arden Estates

450 Stratford Road, Solihull - B90 4AQ

0121 745 5888 • solihull@ardenestates.co.uk •