



**Apt 1, Waddesdon House 10-12 Gorcott Lane, Shirley**

Solihull

In Excess of **£230,000**



# Apartment 1

Waddesdon House 10-12 Gorcott Lane,  
Solihull

Beautiful ground floor 2-bed apartment in Dickens Heath village. Private patio, Lounge/diner, modern kitchen, master bed with en suite, second bed, family bath, 2 secure underground parking spaces. Council Tax band: C

Tenure: Leasehold

EPC Energy Efficiency Rating: B

EPC Environmental Impact Rating: B

- Private patio area and access to a larger gated communal garden
- No Chain
- Two Spacious Bedrooms
- Two allocated underground parking spaces
- Ground Floor Convenience
- Modern Open-Plan Living
- Two Well-Appointed Bathrooms
- Well-Maintained & Move-In Ready
- Prime Dickens Heath Location
- Excellent Transport Links









You can include any text here. The text can be modified upon generating your brochure.





# Apartment, Waddesdon House, Dickens Heath

## Ground Floor

Total Area Approx  
66.0 Sq M  
710.41 Sq Ft

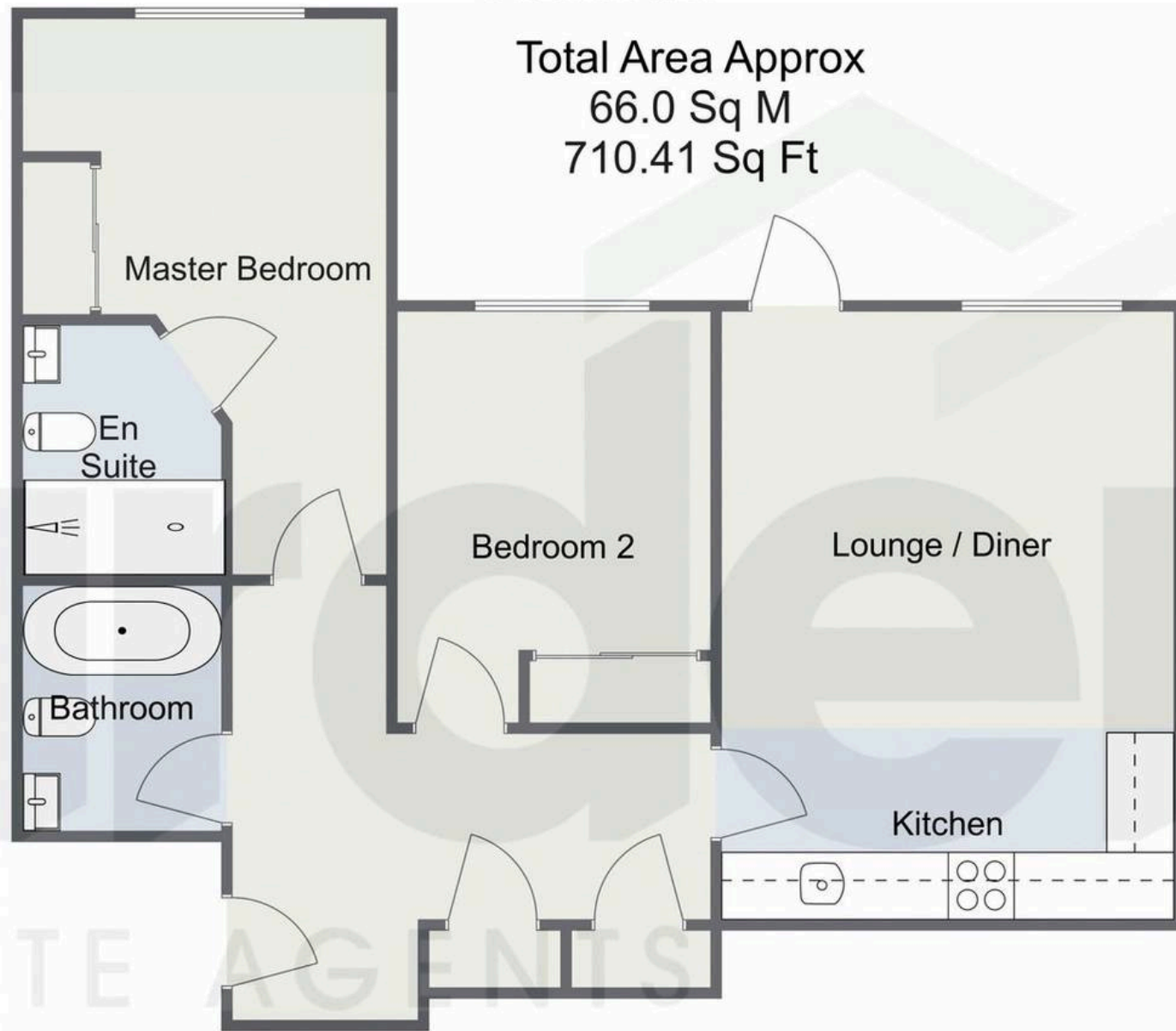

For illustrative purposes only. Decorative finishes, fixtures & fittings do not represent the current state of the property. Measurements are approximate & not to scale. Floor Plans made using RoomSketcher.





## Arden Estates

450 Stratford Road, Solihull – B90 4AQ

0121 745 5888 • [solihull@ardenestates.co.uk](mailto:solihull@ardenestates.co.uk) •