



Flat 16, Homenash House St. Georges Lane North, Worcester

Worcester

Offers in Region of £70,000

Flat 16

Homenash House St. Georges Lane North,
Worcester

A one bedroom, retirement property for over 60s situated in Barbourne, within walking distance of local amenities. In the event of the buyers being a couple, one must be over the age of 60 years and the other over 55. This delightful ground-floor apartment offers a rare opportunity to enjoy independent living with the comfort of a supportive and sociable environment. Set within a well-established development built in 1987, the property is part of a secure leasehold complex comprising 65 one- and two-bedroom flats, many of which are designed to mobility and wheelchair-accessible standards.

Council Tax band: B

Tenure: Leasehold

EPC Energy Efficiency Rating: C

EPC Environmental Impact Rating: D

- Ground Floor Apartment
- Direct Access to Garden
- Communal Lounge
- Shared Gardens
- Over 60's
- Modern Shower Room





You can include any text here. The text can be modified upon generating your brochure.



St Georges Lane North, Worcester

Ground Floor



Total Area
Approx
38.1 sq m
410.1 sq ft

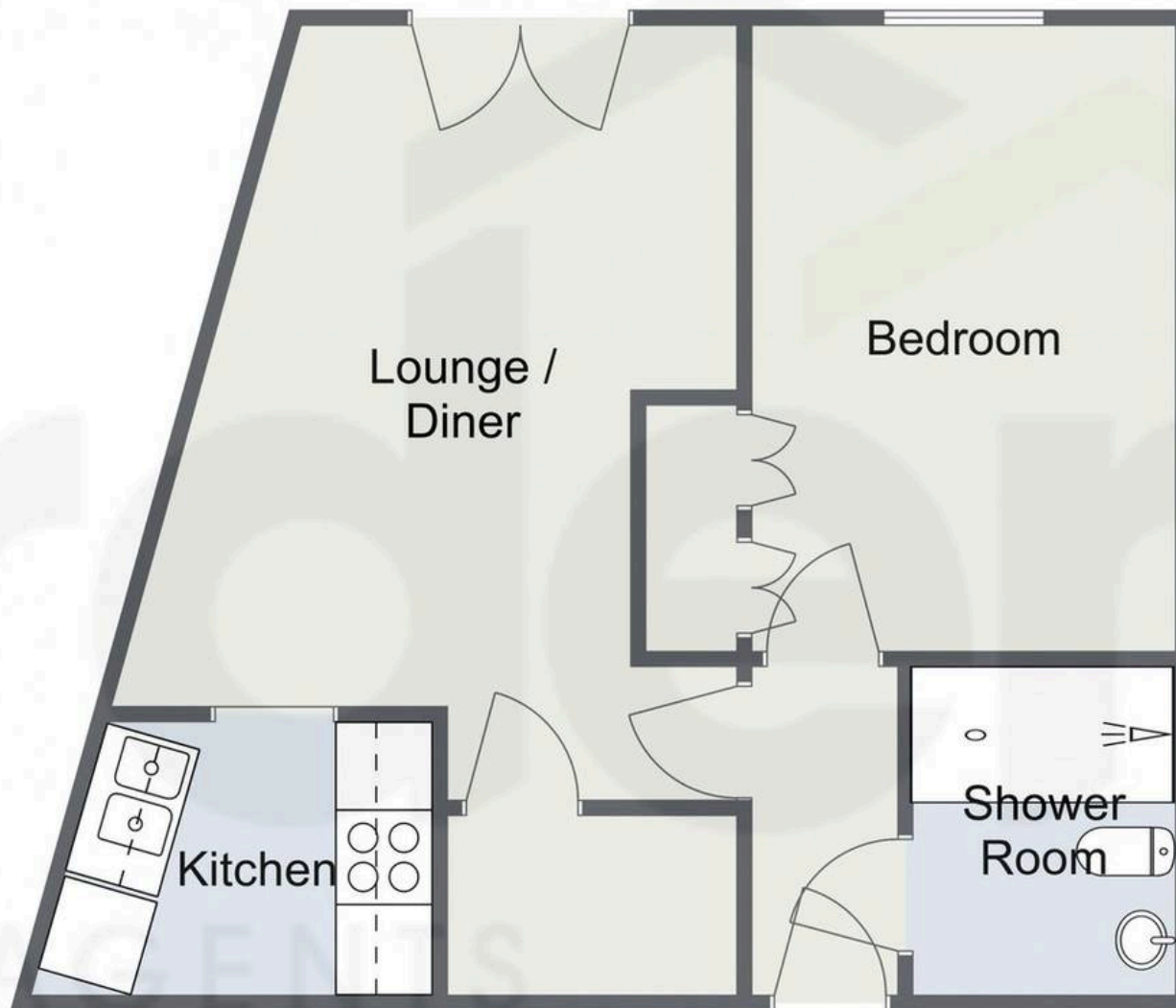

For illustrative purposes only. Decorative finishes, fixtures & fittings do not represent the current state of the property. Measurements are approximate & not to scale.
Floor Plans made using RoomSketcher.



Arden Estates

Arden Estate Agents, 15 Foregate Street – WR1 1DB

01905 958 290 • worcester@ardenestates.co.uk •