

**472 Alcester Road South, Birmingham**

Birmingham

In Excess of £370,000



# 472 Alcester Road South

Birmingham, Birmingham

Spacious 3-bed detached home with potential for full renovation. Two reception rooms, conservatory, garage, south-facing garden. Ideal project for modern living.

Council Tax band: D

Tenure: Freehold

EPC Energy Efficiency Rating: E

EPC Environmental Impact Rating: E

- Three Bedrooms
- Requires Full Modernisation
- 2 Reception Rooms
- Conservatory
- Southernly Facing Garden









You can include any text here. The text can be modified upon generating your brochure.



Alcester Road South, Birmingham  
Ground Floor

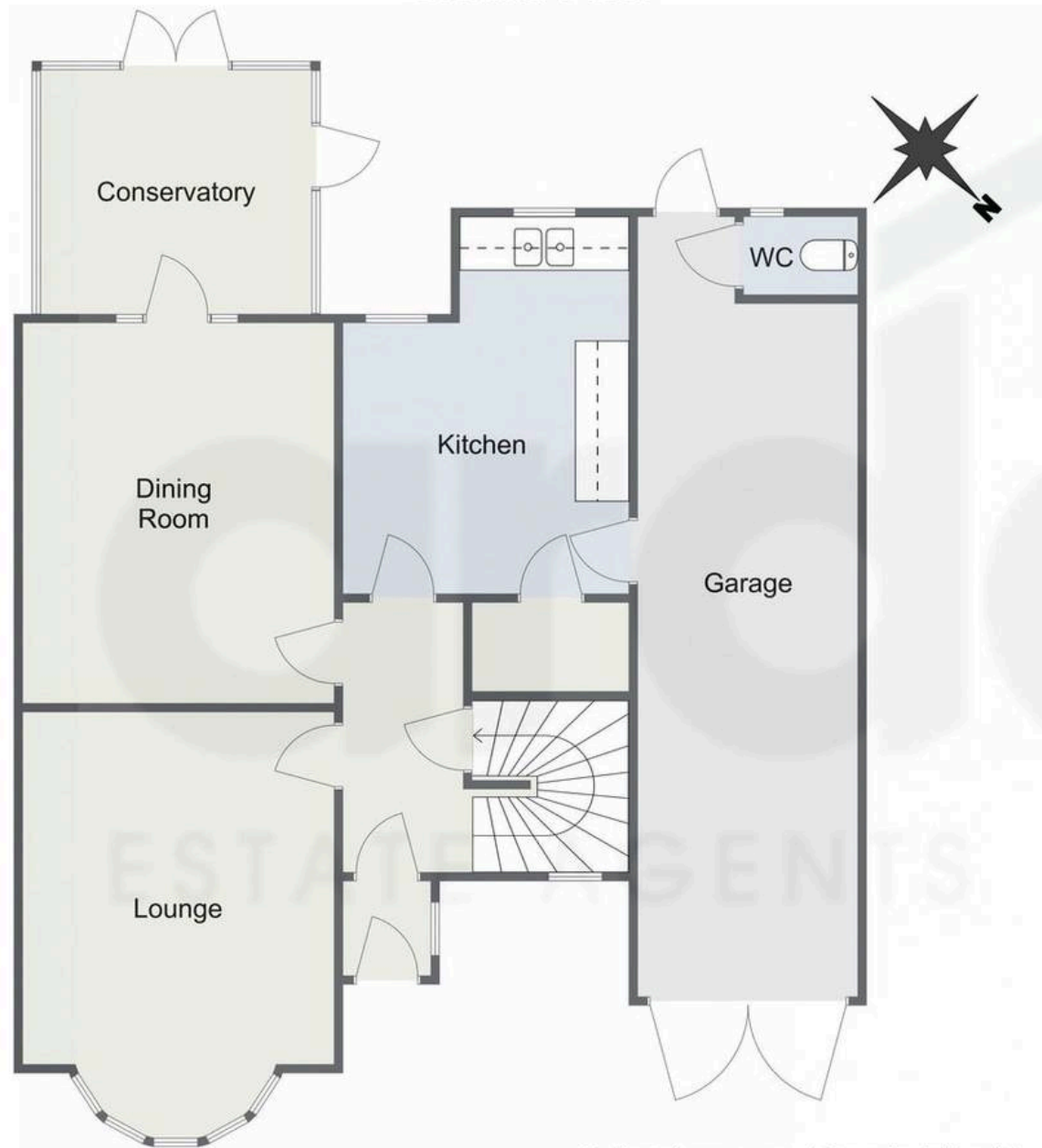

First Floor

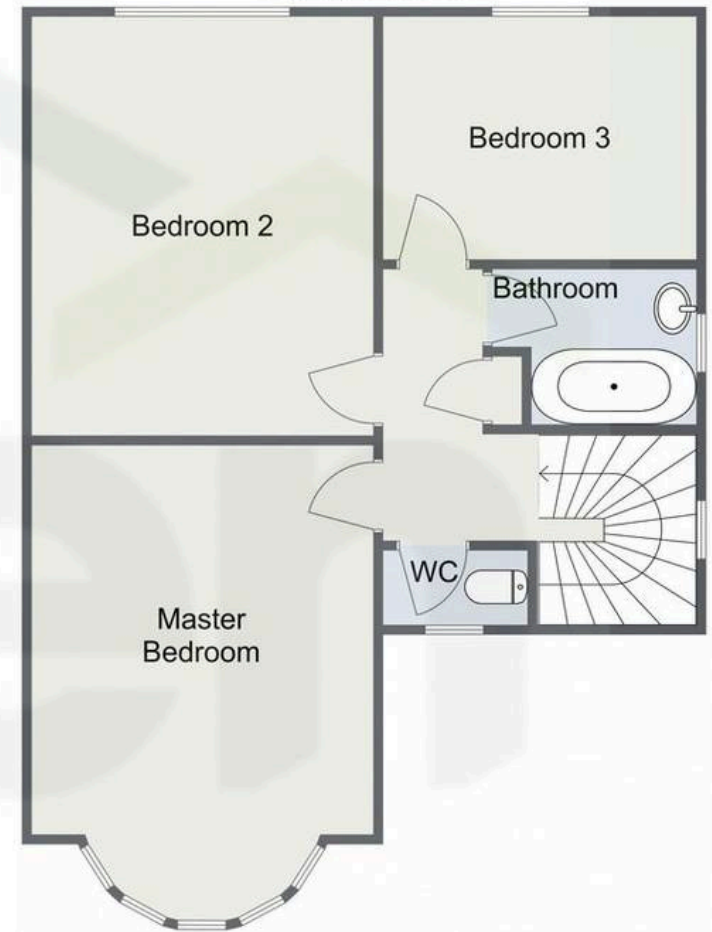

Total Area Approx  
137.1 Sq M  
1475.7 Sq Ft

For illustrative purposes only. Decorative finishes, fixtures & fittings do not represent the current state of the property. Measurements are approximate & not to scale.  
Floor Plans made using RoomSketcher.





## Arden Estates

450 Stratford Road, Solihull - B90 4AQ

0121 745 5888 • [solihull@ardenestates.co.uk](mailto:solihull@ardenestates.co.uk) •