





# Honiton Close, Northfield, Birmingham, B31 1TH

Offers Over £220,000

🛏️ 3 🚿 1 🚻 1



- NO CHAIN
- Open Plan Kitchen / Diner
- Downstairs Shower Room
- Close to Amenities
- Three Bedrooms
- Spacious Lounge
- Rear Garden
- Great for Public Transport





Honiton Close, Birmingham  
Ground Floor

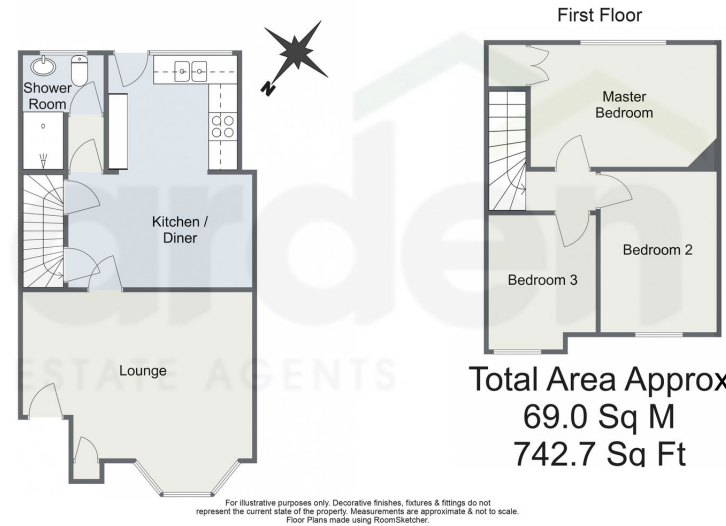

**\*NO CHAIN\***

Introducing this well presented and spacious three-bedroom terraced property, ideally located in the sought-after area of Northfield, Birmingham. The home boasts a welcoming lounge, an open-plan kitchen and dining area, a convenient downstairs shower room, and a lovely rear garden.

32925, 9:29 AM

Energy performance certificate (EPC) - Find an energy certificate - GOV.UK

Energy performance certificate (EPC)			
17 Honiton Close BIRMINGHAM B15 1TH	Energy rating <b>C</b>	Valid until 28 March 2035	Certificate number 2116-1347-1038-4002-3721
Property type Total floor area	Mid-terrace house 73 square metres		
<b>Rules on letting this property</b>			
Properties can be let if they have an energy rating from A to E.			
You can read <a href="https://www.gov.uk/guidance/landlords-on-the-requirements-and-exemptions">guidance for landlords on the regulations and exemptions</a> ( <a href="https://www.gov.uk/guidance/landlords-on-the-requirements-and-exemptions">https://www.gov.uk/guidance/landlords-on-the-requirements-and-exemptions</a> ).			
<b>Energy rating and score</b>		The graph shows this property's current and potential energy rating.	
This property's energy rating is C. It has the potential to be B.		Properties get a rating from A (best) to G (worst) and a score. The better the rating and score, the lower your energy bills are likely to be.	
<a href="#">See how to improve this property's energy efficiency.</a>		For properties in England and Wales: the average energy rating is D the average energy score is 60	
Score	Energy rating	Current	Potential
92+	A		
81-91	B		
69-80	C	71 C	66 B
55-68	D		
39-54	E		
21-38	F		
1-20	G		

<https://find-energy-certificate.service.gov.uk/energy-certificate/2116-1347-1038-4002-3721/summary>

14

For more information on this house or to arrange a viewing please call the office on:

**0121 453 4349**

Alternatively, you can scan the QR to view all of the details of this property online.



**arden**  
ESTATE AGENTS