

Bronte Close, Shirley, Solihull, B90 3DR

Offers Over £435,000

🛏 4 🚿 2 🚲 1



- Four Bedroom Recently Renovated Bungalow
- Outside Home Office With Underfloor Heating, Electricity & Wi-Fi Booster
- Garage
- Utility / Shower Room
- Log Burner In The Lounge / Kitchen / Diner
- Large Driveway
- Within Close Proximity To Local Amenities & Transport Links
- Large Rear Garden

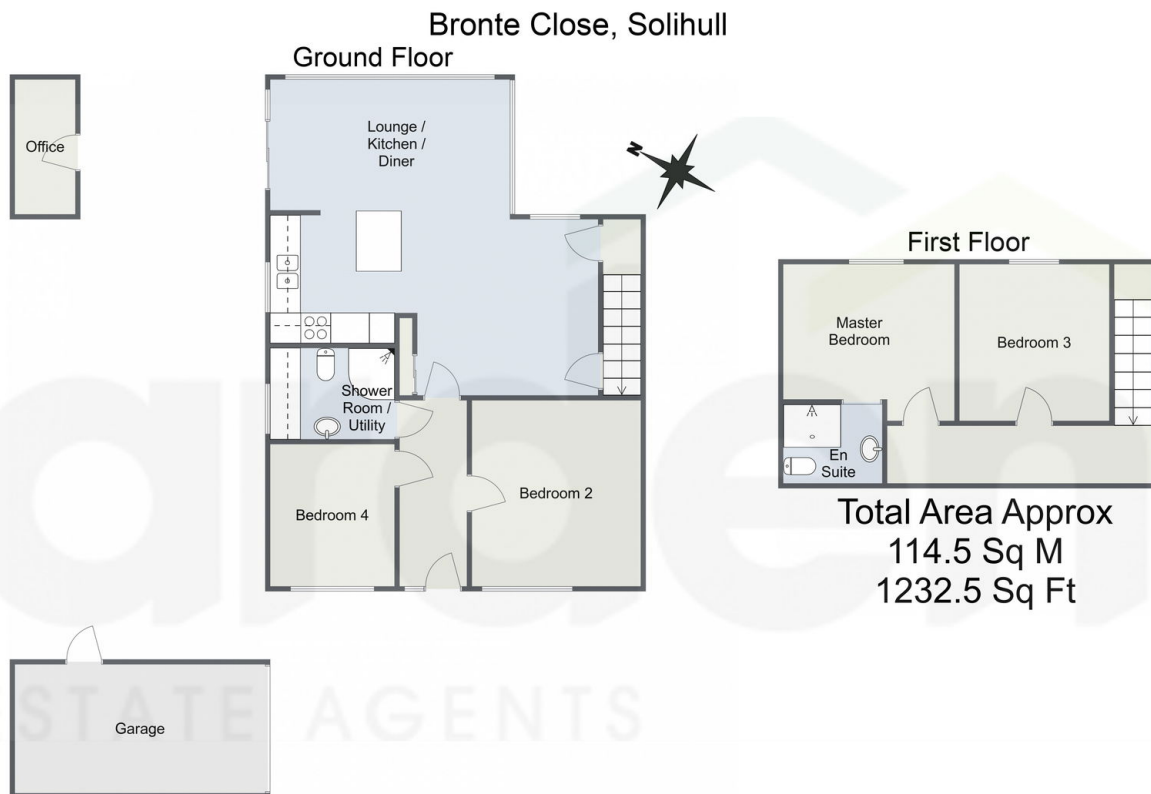

For illustrative purposes only. Decorative finishes, fixtures & fittings do not represent the current state of the property. Measurements are approximate & not to scale. Floor Plans made using RoomSketcher.

UNEXPECTEDLY BACK ON MARKET - This beautifully presented and recently refurbished semi-detached bungalow has been thoughtfully extended to offer modern, spacious living while retaining a warm and inviting feel. Featuring underfloor heating downstairs, a stunning open-plan living space with a log burner, and a fully equipped outdoor home office, this property is perfect for those seeking comfort, style, and practicality. With a large driveway providing ample parking, this home is ready to move into and enjoy.