



Mercot Close, Oakenshaw South, Redditch B98 7YY

Offers In Region Of £285,000

3 1 1



This modern and well-presented three-bedroom semi-detached house, located in the sought-after Oakenshaw South area, is being sold with no upward chain. The property features well-proportioned living spaces, a beautifully maintained rear garden, driveway parking, and a garage.

The property briefly comprises an entrance hallway with stairs leading to the first floor, a spacious lounge featuring a wall-mounted contemporary fire, and a modern kitchen/diner offering ample space for a dining table and chairs. The kitchen is fitted with a range of stylish gloss wall and base units, including some integrated appliances, and has patio doors opening onto the garden. Upstairs, the first-floor landing includes built-in storage and leads to the master bedroom with built-in wardrobes, two further well-proportioned bedrooms—one of which also features built-in wardrobes—and the main bathroom, complete with a shower over the bath.

The property benefits from driveway parking with vehicular access to the garage, complemented by a front lawn. The beautifully maintained rear garden features a paved patio, a lawn with planted borders, and is enclosed by fenced boundaries. Additionally, there is convenient pedestrian access from the garden to the garage.

Kitchen/Diner - 4.26m x 2.48m (13'11" x 8'1")

Lounge - 2.66m x 4.46m (8'8" x 14'7")

Garage - 2.5m x 5m (8'2" x 16'4")

Master Bedroom - 2.35m x 3.81m (7'8" x 12'6")

Bedroom 2 - 2.36m x 2.49m (7'8" x 8'2")

Bedroom 3 - 1.73m x 2.84m (5'8" x 9'3")

Bathroom - 1.69m x 1.54m (5'6" x 5'0")



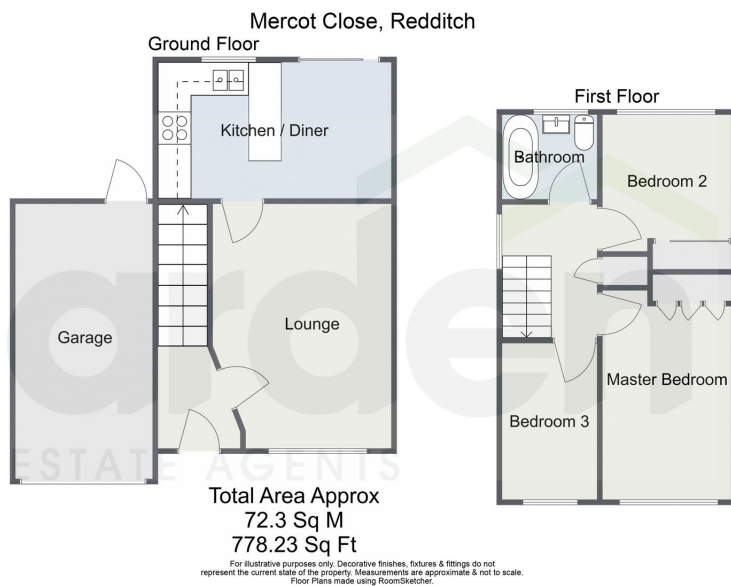

- Well Presented Semi-Detached House
- Spacious Lounge
- Beautifully Maintained Rear Garden
- Garage
- Three Well-Proportioned Bedrooms
- Modern Kitchen/ Diner
- Driveway Parking
- No Upward Chain



For more information on this house or to arrange a viewing please call the office on:

01527 540 654

Alternatively, you can scan the QR to view all of the details of this property online.

