



Arley Close, Church Hill South, Redditch B98 9JF

£195,000

3 1 1



The accommodation comprises an enclosed porch with built-in storage, an inviting entrance hallway with stairs leading to the first floor, and a guest WC. The ground floor features a modern kitchen/diner fitted with a range of stylish gloss wall and base units, as well as a spacious lounge with access to the garden via a rear porch. Upstairs, the first-floor landing leads to the master bedroom, a second double bedroom, a third single bedroom, and a family bathroom with built-in storage.

Outside, the property is approached by a pathway leading through a lawned front garden, bordered by a picket fence. The low-maintenance rear garden features a neatly lawned area and a paved patio, all enclosed within secure fenced boundaries.

WC - 1.73m x 0.96m (5'8" x 3'1")

Kitchen/Diner - 3.41m x 4.78m (11'2" x 15'8") max

Lounge - 4.42m x 3.22m (14'6" x 10'6")

Master Bedroom - 3.9m x 3.38m (12'9" x 11'1")

Bedroom 2 - 4.12m x 3.38m (13'6" x 11'1") max

Bedroom 3 - 2.99m x 1.94m (9'9" x 6'4")

Bathroom - 1.92m x 1.81m (6'3" x 5'11")

Please read the following: These particulars are for general guidance only and are based on information supplied and approved by the seller. Complete accuracy cannot be guaranteed and may be subject to errors and/or omissions. They do not constitute a contract or part of a contract in any way. We are not surveyors or conveyancing experts therefore we cannot and do not comment on the condition, issues relating to title or other legal issues that may affect this property. Interested parties should employ their own professionals to make enquiries before carrying out any transactional decisions. Photographs are provided for illustrative purposes only and the items shown in these are not necessarily included in the sale, unless specifically stated. The mention of any fixtures, fittings and/or appliances does not imply that they are in full efficient working order and they have not been tested. All dimensions are approximate. We are not liable for any loss arising from the use of these details.



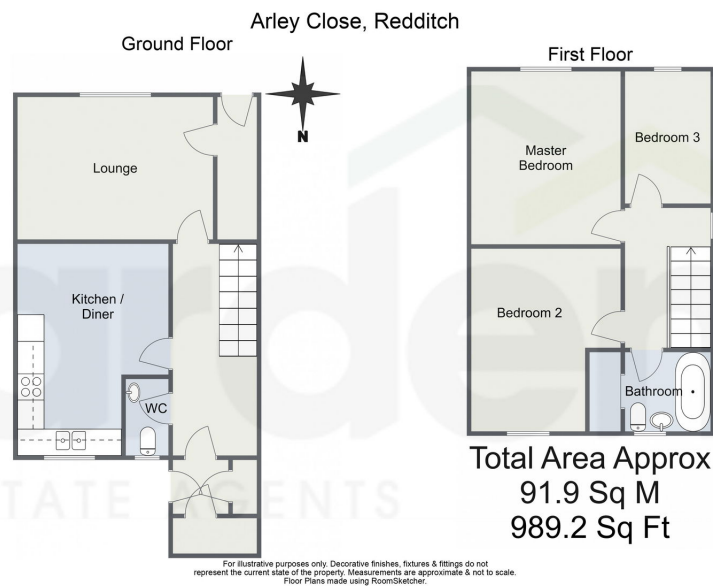

- Beautifully Presented End Terrace
- Spacious Lounge
- Bathroom and Guest WC
- Ample Storage
- Three Bedrooms
- Modern Kitchen/ Diner
- Low Maintenance Rear Garden
- Communal Parking



For more information on this house or to arrange a viewing please call the office on:

01527 540 654

Alternatively, you can scan the QR to view all of the details of this property online.

