



Dice Pleck, West Heath, Birmingham, B31 3XW

Offers Over £350,000

🛏️ 4 🪑 2 🚗 1



- Four Bedrooms
- Modern Kitchen
- Two Bathrooms
- Rear Garden
- Garage
- Lounge / Diner
- Conservatory
- Downstairs WC
- Off Road Parking
- Close to Good Schools, Transport Links and Amenities



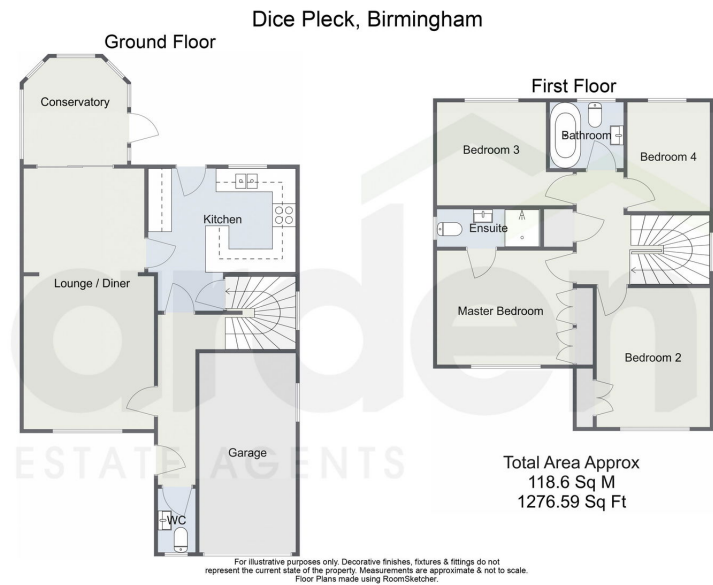

NO ONWARD CHAIN

Introducing this beautifully presented and spacious four-bedroom family home, ideally located in the peaceful and sought-after area of West Heath, Birmingham, featuring a bright lounge/diner, modern kitchen, two bathrooms, a conservatory, off-road parking, and a garage.

For more information on this house or to arrange a viewing please call the office on:

0121 453 4349

Alternatively, you can scan the QR to view all of the details of this property online.



arden
ESTATE AGENTS