



Barn Meadow Close, Northfield, Birmingham, B31 5AJ

£285,000

3 1 1



- Three Bedrooms
- Bright Lounge with Storage
- Modern Kitchen / Diner
- Family Bathroom
- Downstairs WC
- Rear Garden
- Off Road Parking
- Entrance Hall
- Close to Amenities
- Solar Panels - Owned Outright





Barn Meadow Close, Northfield, Birmingham
Ground Floor

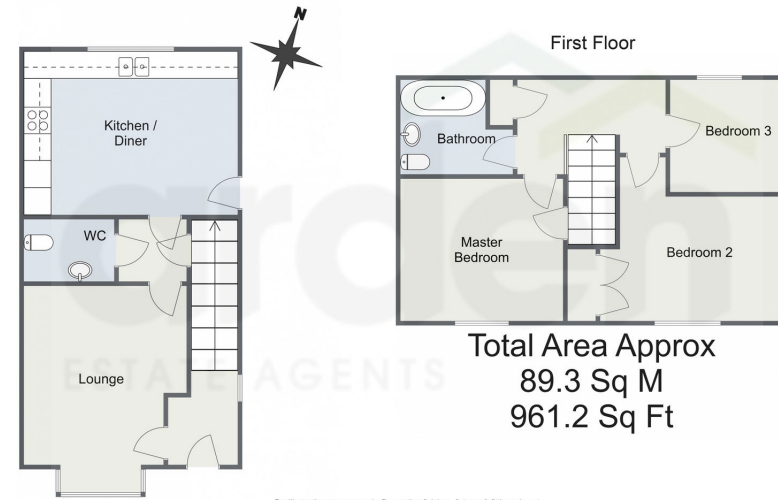

Total Area Approx
89.3 Sq M
961.2 Sq Ft

For illustrative purposes only. Decorative finishes, fixtures & fittings do not represent the current state of the property. Measurements are approximate & not to scale. Floor Plans made using RoomSketcher.

This three bedroom, terraced property boasts a range of qualities, including owned solar panels for energy efficiency, off-road parking, a bright, airy lounge, spacious kitchen/diner, downstairs WC and upstairs, you'll find a contemporary family bathroom. To the rear, a charming garden provides a peaceful outdoor retreat.

For more information on this house or to arrange a viewing please call the office on:

0121 453 4349

Alternatively, you can scan the QR to view all of the details of this property online.

