





11 Swinton Lane  
Offers Over £425,000

3 2 3





Available for sale for the first time since the 1940s, this three bedroom detached family home is ready for you to put your own stamp on it. Benefitting from two reception rooms, study, kitchen/ breakfast room, downstairs w/c, three bedrooms and bathroom. Swinton Lane overlooks Worcester Golf and Country Club and offers scope to extend (subject to planning permission). We highly recommend a viewing for this CHAIN FREE property.

Approaching the property you are met with a

#### Rooms:

**Lounge Diner** - 8.18m x 3.65m (26'10" x 11'11") max

**Family Room** - 6m x 3.35m (19'8" x 10'11")

**Study** - 2.48m x 1.89m (8'1" x 6'2")

**WC** - 1.9m x 0.88m (6'2" x 2'10")

**Kitchen/Breakfast Room** - 3.95m x 3.6m (12'11" x 11'9") max

#### Stairs To First Floor Landing

**Main Bedroom** - 3.96m x 3.66m (12'11" x 12'0")

**Bedroom 2** - 4.44m x 3.49m (14'6" x 11'5") max

**Bedroom 3** - 2.32m x 2.01m (7'7" x 6'7")

**Bathroom** - 1.82m x 1.81m (5'11" x 5'11")



Swinton Lane, Worcester

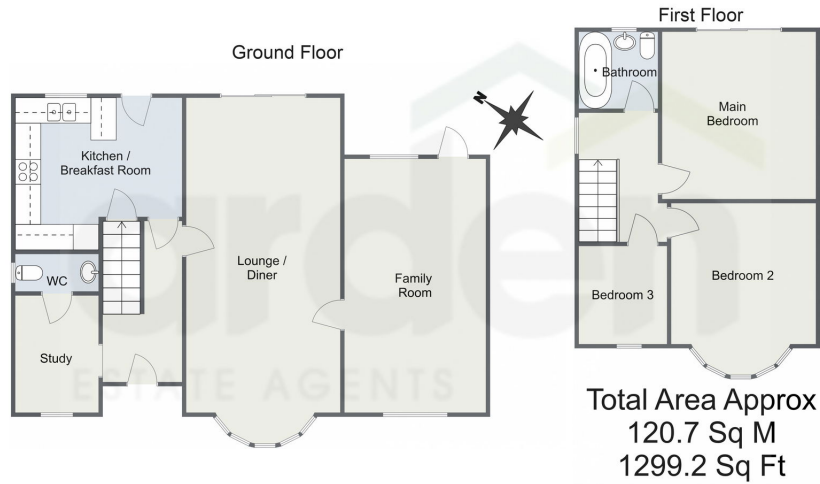

For illustrative purposes only. Decorative finishes, fixtures & fittings do not represent the current state of the property. Measurements are approximate & not to scale. Floor Plans made using RoomSketcher.

- Detached Family Home
- Overlooking Golf Course
- Scope to Extend (STPP)
- Popular WR2 Location
- Front & Rear Gardens
- Chain Free

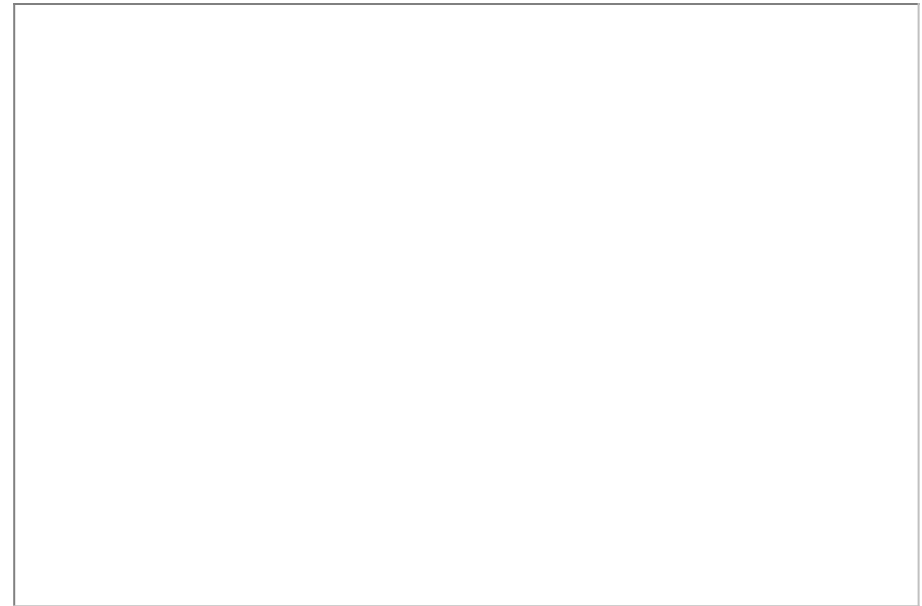

For more information on this house or to arrange a viewing please call the office on:

**01905 958 290**

Alternatively, you can scan the QR to view all of the details of this property online.



**arden**  
ESTATE AGENTS