



1 Westfield Road, Fernhill Heath

£425,000

🛏️ 4 🚿 2 🛋️ 2



WC - 1.74m x 1.24m (5'8" x 4'0")

Lounge - 3.49m x 2.99m (11'5" x 9'9")

Kitchen/Diner - 9.06m x 3.95m (29'8" x 12'11") max

Conservatory - 3.13m x 2.69m (10'3" x 8'9")

Utility Room - 4.12m x 1.24m (13'6" x 4'0")

Family Room - 4.48m x 3.13m (14'8" x 10'3") max

Stairs To First Floor Landing

Main Bedroom - 5.03m x 3.4m (16'6" x 11'1")

Bedroom 2 - 3.31m x 3.02m (10'10" x 9'10")

Bedroom 3 - 3.85m x 2.67m (12'7" x 8'9") max

Bedroom 4 - 2.74m x 2.05m (8'11" x 6'8")

Bathroom - 3.67m x 1.68m (12'0" x 5'6") max



Westfield Road, Fernhill Heath, Worcester
Ground Floor

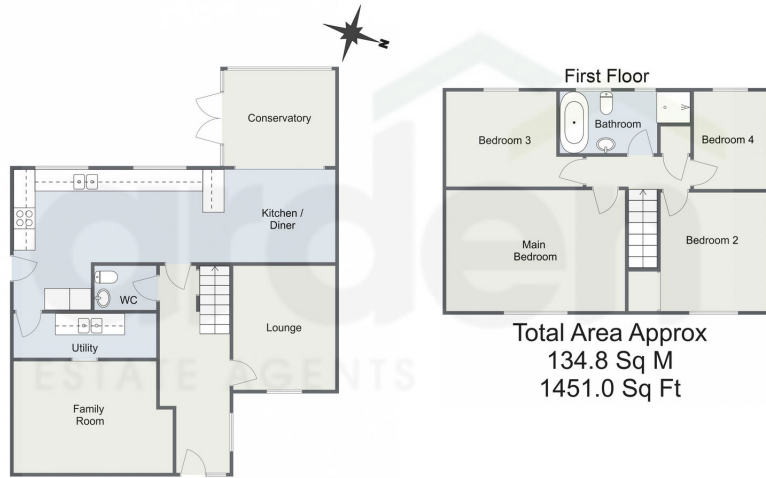

For illustrative purposes only. Decorative finishes, fixtures & fittings do not represent the current state of the property. Measurements are approximate & not to scale. Floor Plans made using RoomSketcher.



For more information on this house or to arrange a viewing please call the office on:
01905 958 290

Alternatively, you can scan the QR to view all of the details of this property online.

