



Woodside, Hatfield Lane, Norton, Worcester, WR5 2PY
Offers Over £550,000

4 2 3



This impressive four-bedroom detached family home on Hatfield Lane, Norton, offers spacious and versatile accommodation, perfect for modern living. Situated in a sought-after location, this property combines practical design with stylish features, making it an excellent choice for families.

Approaching the property, you're welcomed by a lovely front garden with mature borders and a block paved driveway. Entering the home, you are greeted by a well-laid-out ground floor. The generously sized lounge, with direct access to the rear garden, provides a bright and comfortable space for relaxation and entertaining. The fireplace at the centre of the room is a charming focal point.

Adjacent to the lounge is the dining room, creating a seamless flow for hosting dinner parties or family meals. The modern kitchen is well-equipped with real wood worktops, ample counter space and storage, complemented by a convenient utility room for additional practicality. The ground floor also benefits from a playroom/study with a large storage cupboard, ideal for working from home or as a versatile family area with a large storage cupboard, and a downstairs WC.

Upstairs, the first floor features four well-proportioned bedrooms. The master bedroom includes an en-suite shower room, providing a touch of luxury and privacy. Three additional bedrooms offer flexibility for family members or guests, and all bedrooms offer built-in wardrobes. The modern family bathroom, complete with contemporary fixtures, serves the remaining bedrooms.

The rear garden offers space for outdoor activities, with room for entertaining, gardening, or simply relaxing in a peaceful setting. There is a single garage for added storage and convenience, as well as an electric car charging point to the front.

The property also features oak internal doors, oak flooring and modern downlights throughout. With its spacious layout, modern features, and desirable location, this home is perfect for families seeking a balance of comfort and practicality. Don't miss the opportunity to make this property your own.



Hatfield Lane, Norton
Ground Floor

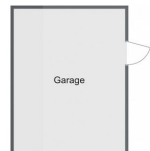

First Floor

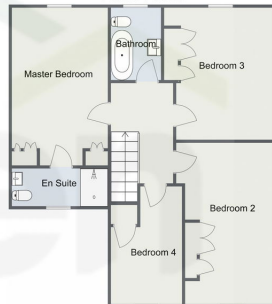

Total Area Approx
160.2 Sq M
1724.4 Sq Ft

For illustrative purposes only. Decorative finishes, fixtures & fittings do not represent the current state of the property. Measurements are approximate & not to scale. Floor Plans made using RoomSketcher.

- Modern Family Home
- Four Bedrooms
- Garage
- Front & Rear Gardens
- Well Maintained
- Home Office

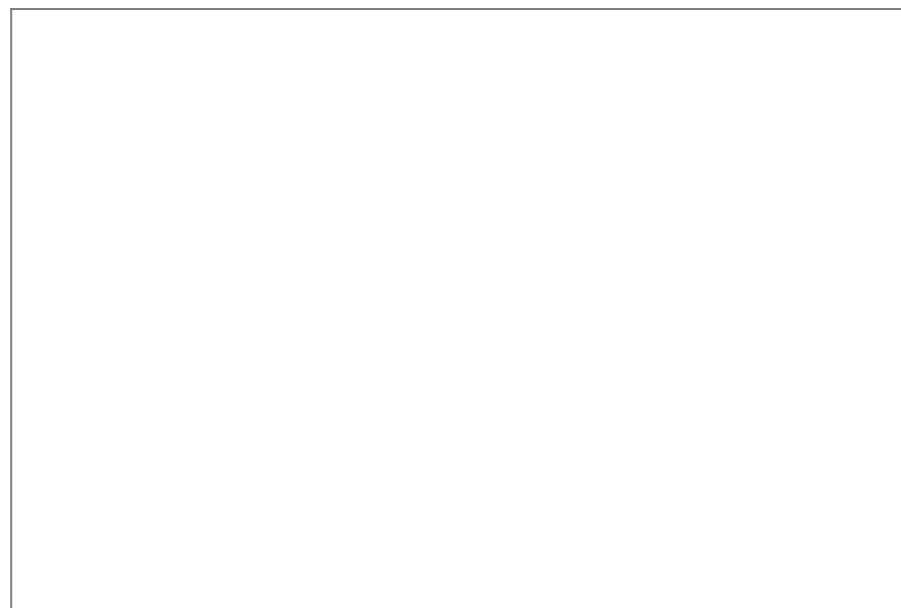

For more information on this house or to arrange a viewing please call the office on:

01905 958 290

Alternatively, you can scan the QR to view all of the details of this property online.



arden
ESTATE AGENTS