



Hollington House, Dixon Close, Enfield, Redditch B97 6AJ

£145,000

🛏️ 2 🚿 1 🚻 1



- Stylish First Floor Apartment • Two Double Bedrooms
- Spacious Lounge/ Diner • Newly Fitted Kitchen
- Contemporary Bathroom • Secure Intercom Entry
- Allocated and Visitor Parking • Well Maintained Communal Grounds





Hollington House, Dixon Close, Redditch

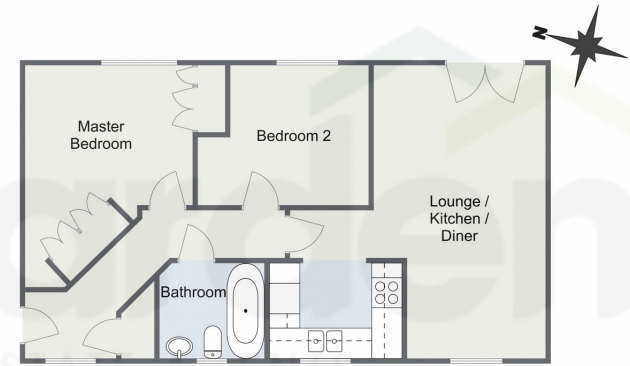

Total Area Approx
59.3 Sq M
638.3 Sq Ft

For illustrative purposes only. Decorative finishes, fixtures & fittings do not represent the current state of the property. Measurements are approximate & not to scale. Floor Plans made using RoomSketcher.

A stylish and well-presented two-bedroom apartment, positioned on the first floor within beautifully maintained grounds. The property benefits from allocated parking and is conveniently located near Redditch Town Centre.



For more information on this house or to arrange a viewing please call the office on:
01527 540 654

Alternatively, you can scan the QR to view all of the details of this property online.

