



## Birchfield Road, Webheath, Redditch B97 4NF

Offers Over £415,000

 4  2  3



- Four Bedrooms
- Family Bathroom & Guest WC
- Dining Room
- Kitchen & Separate Utility
- Delightful Rear Garden
- En-Suite To Master Bedroom
- Lounge
- Orangery
- Home Office
- Sought After Location

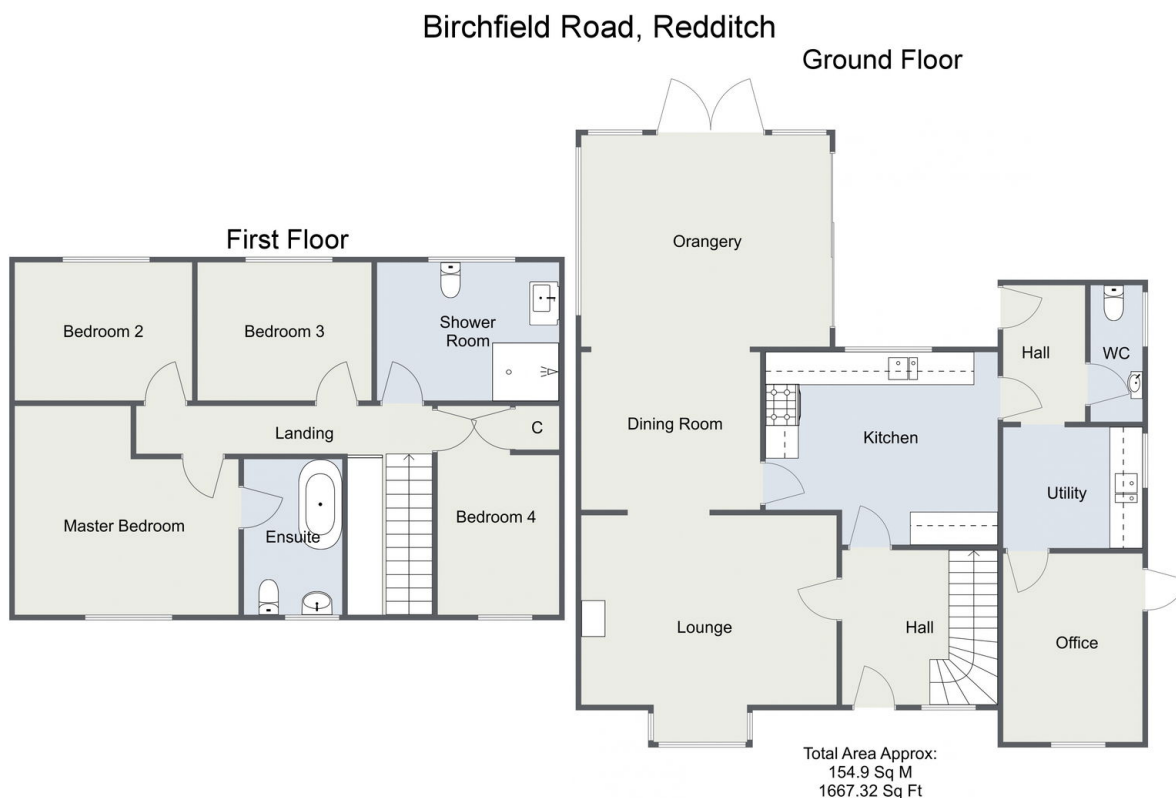

For illustrative purposes only. Decorative finishes, fixtures & fittings do not represent the current state of the property. Measurements are approximate & not to scale. Floor Plans made using RoomSketcher.

***Recently Reduced*** \* An immaculate, contemporary four bedroom detached property, much improved by current owners and offered with an open plan lounge, dining and south facing orangery living space, kitchen with separate utility room, home office/study, en-suite to the master bedroom, modern principal shower room, generous off road parking, stunning landscaped rear gardens and situated in the sought after location of Webheath, Redditch.