



Fairfield Drive, Webheath, Redditch B97 5QF

Offers Over £330,000

 3  2  1



- Wonderfully Appointed Semi-Detached House
- Spacious Lounge
- Bathroom, En-Suite and Shower Room
- Driveway Parking
- Three Well-Proportioned Bedrooms
- Stylish Kitchen/ Diner
- Beautifully Maintained Rear Garden
- EPC - B

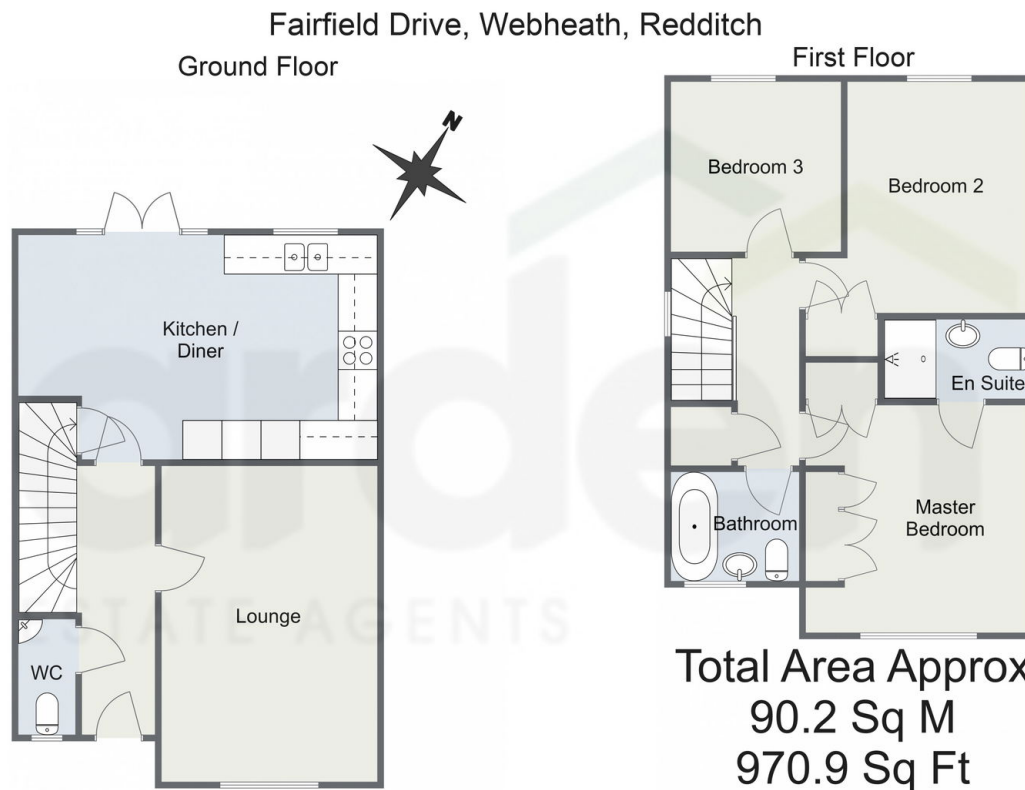

For illustrative purposes only. Decorative finishes, fixtures & fittings do not represent the current state of the property. Measurements are approximate & not to scale. Floor Plans made using RoomSketcher.

A wonderfully appointed three bedroom semi-detached family home, located in the sought after Webheath area. Built in 2019 this property has been further improved and offers modern and stylish interiors, a beautifully maintained rear garden with summerhouse and driveway parking.