

The Glebe, Holt End, Beoley B98 9AW

Offers Over £325,000

3 1 1



- 1920s Semi Detached House
- Dual Aspect Lounge
- Main Bathroom and Guest WC
- Generous South-Facing Garden
- Village Location
- Three Well-Proportioned Bedrooms
- Kitchen/ Diner
- Well-Proportioned Accommodation
- Off Road Parking
- No Upward Chain

The Glebe, Redditch

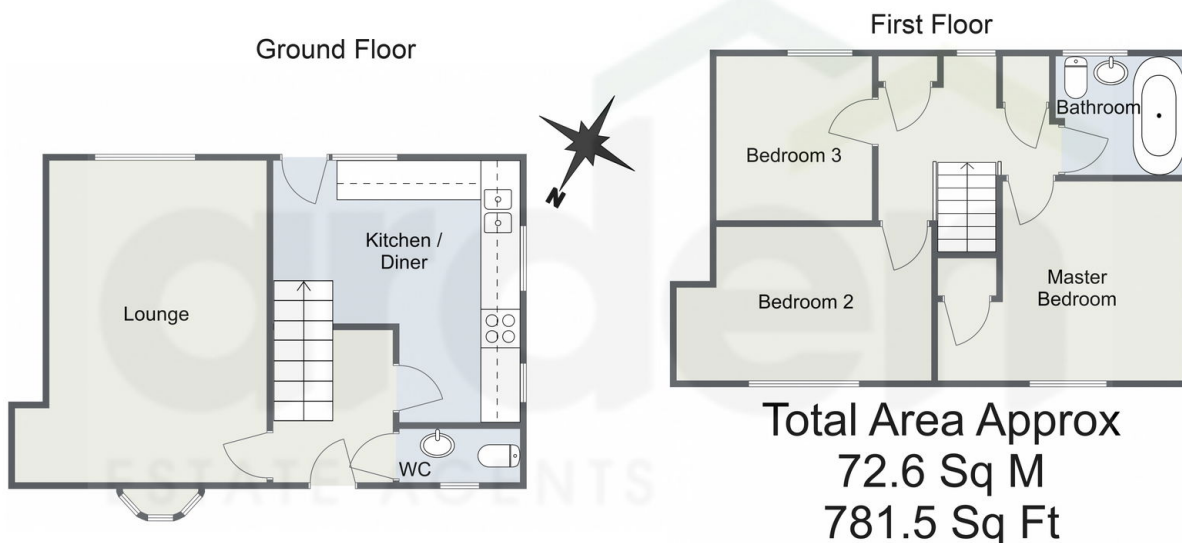

For illustrative purposes only. Decorative finishes, fixtures & fittings do not represent the current state of the property. Measurements are approximate & not to scale. Floor Plans made using RoomSketcher.

This beautifully appointed three-bedroom 1920s semi-detached house, situated in the village of Beoley, is being sold with no upward chain. The property features well-proportioned accommodation that would benefit from some modernisation, a generous south-facing rear garden, and off-road parking.