

Shirehampton Close, Webheath, Redditch, B97 5PF

Offers In Region Of £390,000

🛏 4 🚿 2 🚗 2



- Beautifully Presented Detached Home
- Lounge and Dining Room
- Bathroom, En-Suite and Guest WC
- Tandem Double Garage
- Corner Position
- Four Well-Proportioned Bedrooms
- Breakfast Kitchen and Utility
- Manicured Rear Garden
- Driveway and Carport
- No Upward Chain

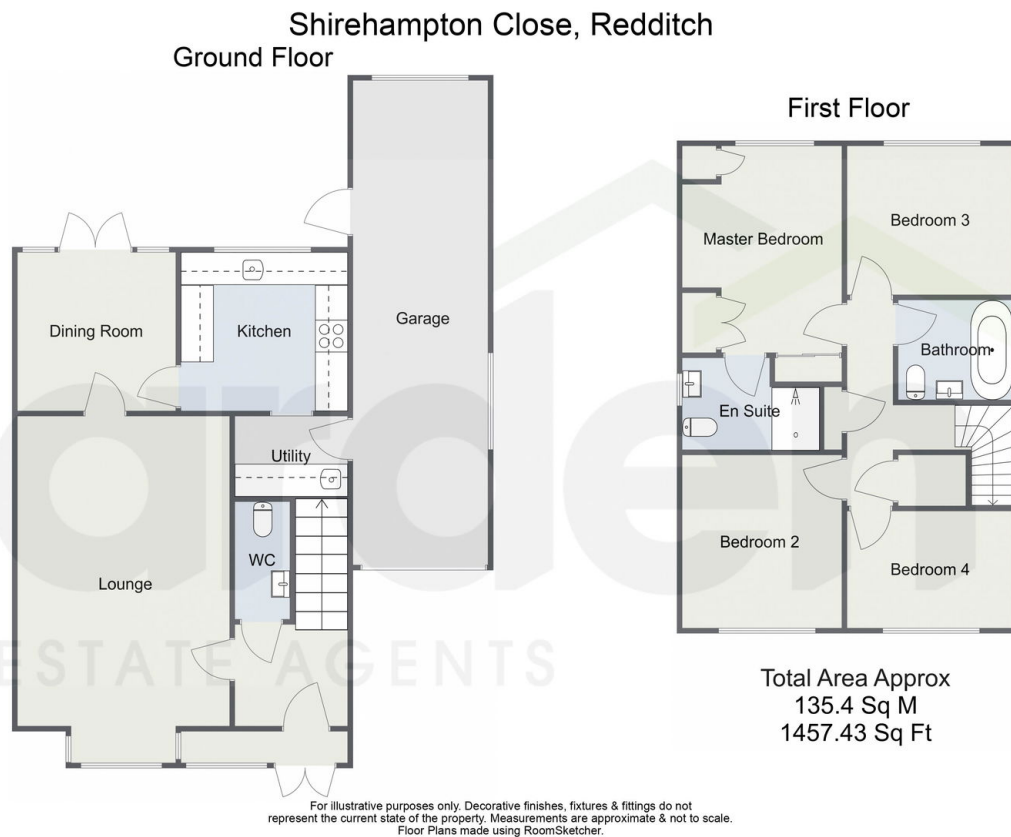

A beautifully presented and wonderfully maintained four-bedroom home, offered for sale with no upward chain, occupying a desirable corner position in the sought-after area of Webheath. The property boasts generously proportioned accommodation, a stunning manicured rear garden, a driveway, a carport, and a garage.