





Tinmeadow Crescent, Rednal, Birmingham, B45 8TH

£200,000

3 1 1





- Three Bedrooms
- Kitchen
- Rear Garden
- Entrance Hall
- Spacious Lounge / Diner
- Family Bathroom
- Driveway for Off Road Parking
- Close to Amenities



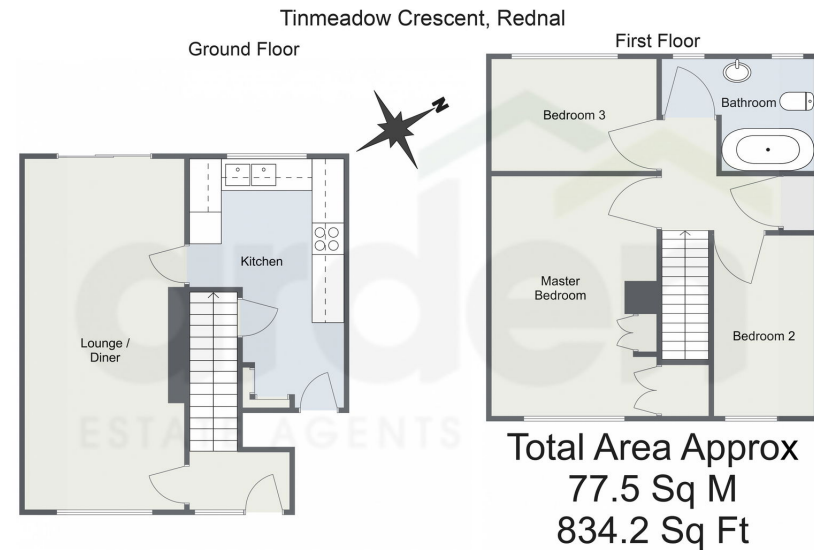

For illustrative purposes only. Decorative finishes, fixtures & fittings do not represent the current state of the property. Measurements are approximate & not to scale. Floor plans made using RoomSketcher.

Introducing this well presented three-bedroom terraced home. Featuring a spacious lounge/diner, a kitchen, a private driveway for off-road parking, a contemporary family bathroom, and a delightful rear garden, this charming property is perfectly situated in the desirable area of Rednal, Birmingham.

11/20/24 1:34 PM Energy performance certificate (EPC) - Find an energy certificate - GOV.UK

Energy performance certificate (EPC)		
7 Tinmeadow Crescent Rednal BIRMINGHAM B48 6TH	Energy rating <b>C</b>	Valid until 3 October 2034
Property type Mid-terrace house		Certificate number 6720-0004-6569-4038-1453
Total floor area 77 square metres		

#### Rules on letting this property

Properties can be let if they have an energy rating from A to E.

You can read [guidance for landlords on the regulations and exemptions](https://www.gov.uk/guidance/landlords-on-the-requirements-and-exemptions) (<https://www.gov.uk/guidance/landlords-on-the-requirements-and-exemptions>).

#### Energy rating and score

This property's energy rating is C. It has the potential to be B.

[See how to improve this property's energy efficiency.](#)

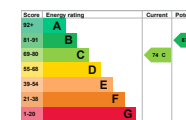

The graph shows this property's current and potential energy rating.

Properties get a rating from A (best) to G (worst) and a score. The better the rating and score, the lower your energy bills are likely to be.

For properties in England and Wales:  
the average energy rating is D  
the average energy score is 60

<https://find-energy-certificate.service.gov.uk/energy-certificate/6720-0004-6569-4038-1453/print.html>

14

For more information on this house or to arrange a viewing please call the office on:

**0121 453 4349**

Alternatively, you can scan the QR to view all of the details of this property online.



**arden**  
ESTATE AGENTS