



Hawkesley Drive, Northfield, Birmingham, B31 4EZ

£195,000

🛏️ 2 🚿 1 🚻 1



- Two Bedrooms
- Kitchen
- Family Bathroom
- Off Road Parking
- Expansive Lounge
- Dining Room
- Rear Garden
- Secured Porch





Hawkesley Drive, Northfield, Birmingham
Ground Floor

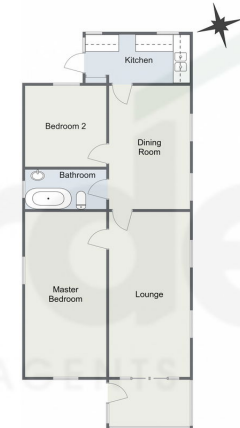

Total Area Approx
73.9 Sq M
795.4 Sq Ft

For illustrative purposes only. Decorative finishes, fixtures & fittings do not represent the current state of the property. Measurements are approximate & not to scale. Floor Plans made using RoomSketcher.

Introducing this two-bedroom detached bungalow, offering an excellent opportunity for modernisation. The property features off-road parking, two reception rooms, a functional kitchen, a family bathroom, and a rear garden. Situated in the popular area of Northfield, Birmingham, this home combines potential and convenience in a sought-after location.

For more information on this house or to arrange a viewing please call the office on:

0121 453 4349

Alternatively, you can scan the QR to view all of the details of this property online.



arden
ESTATE AGENTS