



24 Hennals Avenue, Webheath, Redditch B97 5SB

Offers Over £400,000

 4  2  1



- Beautifully Situated Detached Bungalow
- Spacious L-Shape Lounge
- Breakfast Kitchen
- Beautifully Established Front and Rear Gardens
- Double Garage
- Three/ Four Double Bedrooms
- Separate Dining Room
- Accessible Bathroom
- Ample Off Road Parking
- No Upward Chain

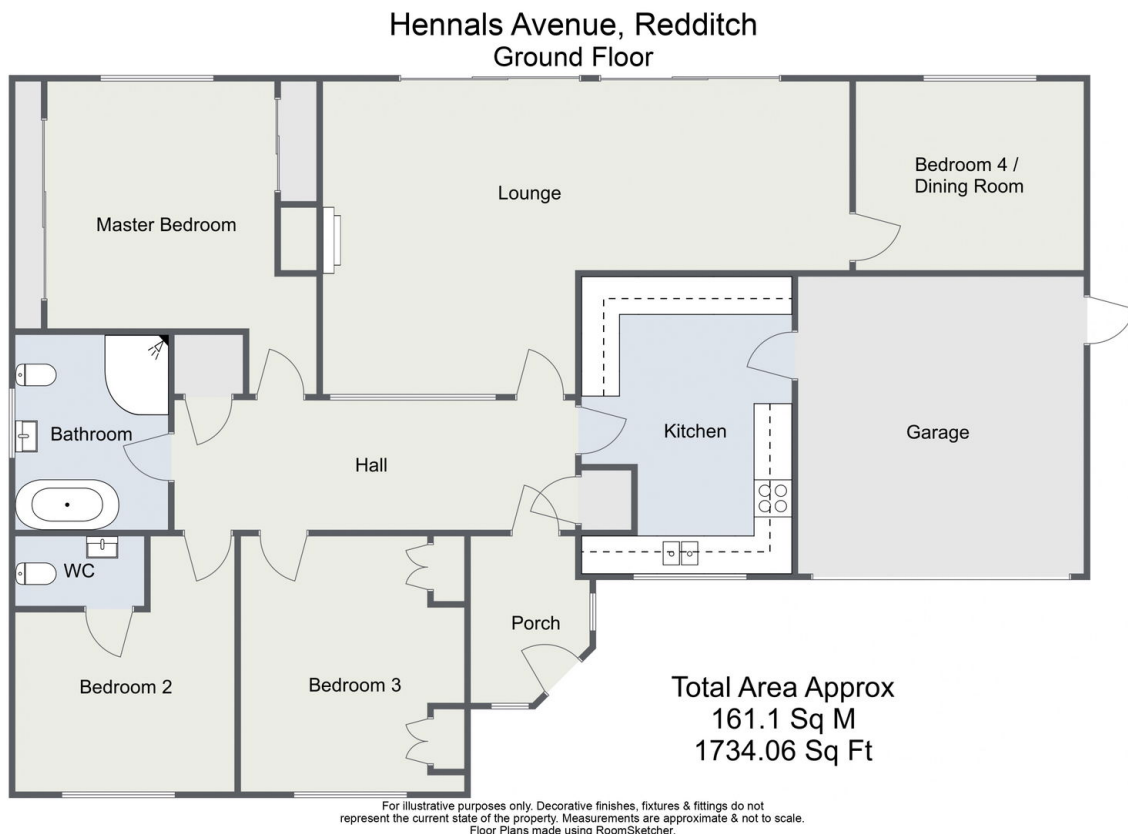

This beautifully situated three/ four bedroom detached bungalow, offered with no upward chain, is located in the sought-after Webheath area. The property provides spacious accommodation, well-established front and rear gardens, ample driveway parking, and a double garage.