



## Burman Close, Shirley, Solihull, B90 2DR

Offers Over £430,000

 2  2  2



- Two Bedroom Bungalow
- Lounge
- Kitchen / Diner
- Home Office
- South Facing Garden
- Fitted Wardrobes & En Suite To Master Bedroom
- Conservatory
- Utility
- Convenient Location
- Near By Shirley Train Station

Burman Close, Shirley  
Ground Floor

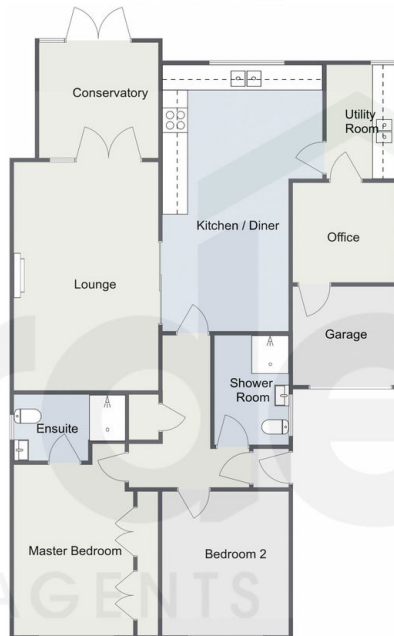

Total Area Approx  
109.4 Sq M  
1177.57 Sq Ft

For illustrative purposes only. Decorative finishes, fixtures & fittings do not represent the current state of the property. Measurements are approximate & not to scale. Floor Plans made using RoomSketcher.

This delightful 2-bedroom detached bungalow is situated in a prime location in Shirley, offering spacious living, off-road parking, and a range of versatile features. Perfect for those looking for single-level living in a convenient and sought-after area, this property is ready to become your next home.