



# Yeomans Close, Astwood Bank, Redditch B96 6ET

Shared Ownership £75,000

🛏️ 2 🚿 1 🚗 1



- 50% Shared Ownership
- Two Bedrooms
- Modern Kitchen and Bathroom
- Sought After Location
- Modern Apartment
- Lounge/ Diner
- Allocated and Visitor Parking
- EPC - B



**\*\* Long Lease \*\*** An excellent opportunity to purchase this modern two-bedroom apartment in Astwood Bank, offered with 50% shared ownership. The property boasts spacious accommodation, as well as both allocated and visitor parking.



Yeomans Close, Astwood Bank

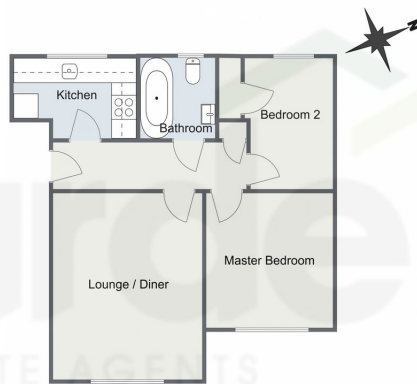

Total Area Approx  
51.3 Sq M  
552.2 Sq Ft

For illustrative purposes only. Decorative finishes, fixtures & fittings do not represent the current state of the property. Measurements are approximate & not to scale. Floor Plans made using RoomSketcher.

**Energy performance certificate (EPC)**

33, Yeomans Close Astwood Bank REDDITCH B96 6ET	Energy rating <b>B</b>	Valid until: 19 March 2025 Certificate number: 0747-2820-6474-9425-1051
Property type	Mid-floor flat	
Total floor area	60 square metres	

**Rules on letting this property**

Properties can be let if they have an energy rating from A to E.

You can read [guidance for landlords on the regulations and exemptions](https://www.gov.uk/guidance/domestic-private-rented-property-minimum-energy-efficiency-standard-landlord-guidance) (<https://www.gov.uk/guidance/domestic-private-rented-property-minimum-energy-efficiency-standard-landlord-guidance>).

**Energy rating and score**

This property's energy rating is B. It has the potential to be B.

[See how to improve this property's energy efficiency.](#)

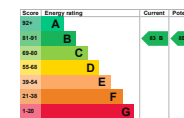

The graph shows this property's current and potential energy rating.

**Properties get a rating from A (best) to G (worst) and a score.** The better the rating and score, the lower your energy bills are likely to be.

For properties in England and Wales:  
the average energy rating is D  
the average energy score is 60

For more information on this house or to arrange a viewing please call the office on:

**01527 540 654**

Alternatively, you can scan the QR to view all of the details of this property online.

