



  
ESTATE AGENTS

It's who  
you move  
with.



# Armstrong Drive, Worcester, WR1 2GB

Offers Over £200,000

🏠 1 🚗 1 🚗 1





Welcome to Chamberlain House, a modern and stylish one-bedroom apartment located on Armstrong Drive in Worcester. This property offers a perfect blend of contemporary design and practical living space, making it ideal for professionals, couples, or investors looking for a comfortable and low-maintenance home.

At the heart of this apartment is a generous open-plan lounge, kitchen, and dining area. This bright, airy space is flooded with natural light, making it a welcoming spot to relax or entertain. The open layout allows for flexible furniture arrangements to suit any lifestyle and taste. The kitchen area offers a range of wall and base units, a built in microwave, hob, extractor, electric oven and there is space for a washing machine and fridge freezer.

The apartment's bedroom is thoughtfully designed, offering a tranquil retreat with ample space for a large bed, wardrobe, and additional storage furniture if desired. Adjacent to the bedroom, the modern bathroom features contemporary fixtures, including a full-size bath, providing a calming environment to unwind. The apartment also includes a spacious hallway and cleverly integrated storage areas, adding to the functionality and ease of living.

Outside, the property offers allocated parking in a secure gated car park.

Located in a vibrant part of Worcester, Chamberlain House is close to local amenities, shops, restaurants, and transportation links, ensuring convenience and connectivity. With its generous size, well-designed layout, and prime location, this property offers both comfort and practicality for modern living. If you're interested in experiencing the charm of Chamberlain House for yourself, please contact us to arrange a viewing. This could be the ideal home or investment opportunity you've been looking for in Worcester.

**Location:** Situated in the popular Diglis area of Worcester it benefits from having playing fields, gym, a hotel and pub. This is an attractive location due to its close proximity to the city centre which offers wine bars, restaurants and shopping. Foregate Street Station is in the city if you need to commute and you are also perfectly positioned for canal and river walks.



Chamberlain House, Armstrong Drive, Worcester

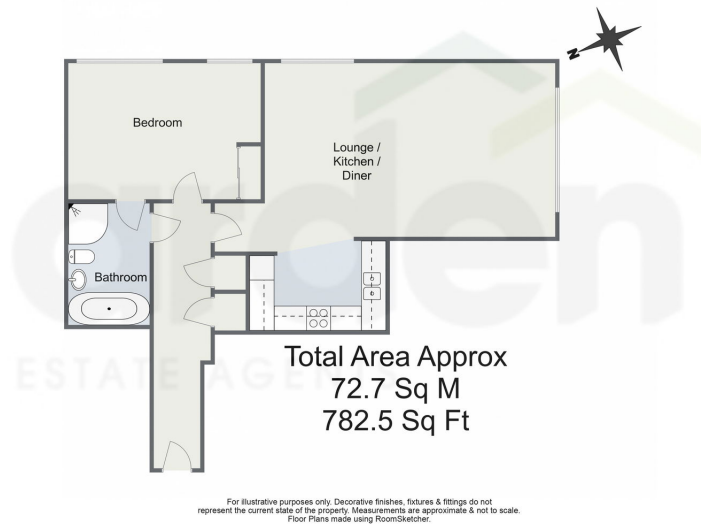

- Chain Free!
- Popular Diglis Location
- Allocated Parking
- Over 700sq ft
- Close to City Centre
- Open Plan Living

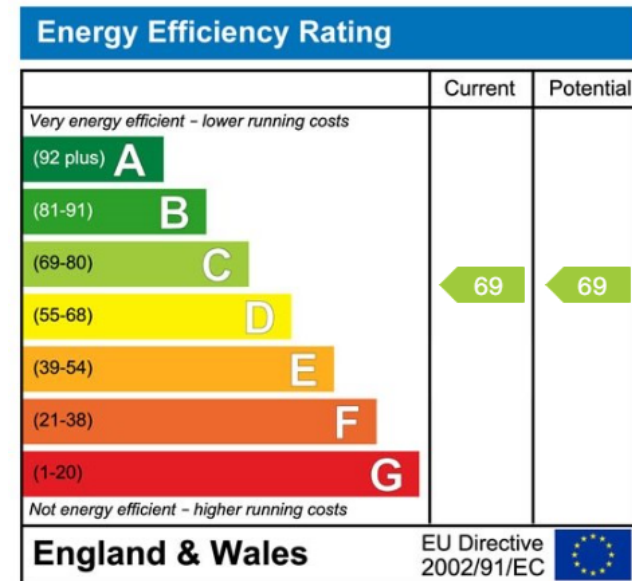

For more information on this house or to arrange a viewing please call the office on:

**01905 958 290**

Alternatively, you can scan the QR to view all of the details of this property online.

