



Vernon Park Road, Worcester, WR2 4NF

£395,000

3 1 2



Discover a beautiful blend of historic charm and modern comfort in this stunning semi-detached Edwardian property, located on the sought-after Vernon Park Road in Worcester. Offering spacious living areas, period features, and a convenient location, this property is perfect for families or anyone seeking a classic home with a contemporary twist.

As you step into the property, you're greeted by the elegant Minton floor and stained-glass windows to the porch, highlighting the charm of the property. To the front, the Lounge is a perfect space for relaxing, with a bay window allowing ample natural light. Adjacent is the Dining Room, which offers a generous area for hosting family dinners and entertaining guests. Both rooms offer original feature fireplaces with gorgeous tiled hearths.

At the rear of the house, the Kitchen Breakfast room has been extended to create a modern yet functional space for cooking and casual dining, equipped with ample counter and storage space. The built in appliances include fridge freezer, washing machine, oven, grill, electric extractor fan and gas hob. From the Kitchen Breakfast room, bifold doors lead out to the patio and garden, perfect for summer entertaining or morning coffees in the fresh air. A staircase leads down to the Cellar, offering potential for further development.

Upstairs houses three well-proportioned bedrooms. The Master Bedroom offers built in wardrobes and overlooks the front of the property, while Bedrooms Two & Three overlook the rear garden. The Bathroom completes this floor, featuring a bath, separate shower, sink and W/C. There is also a convenient storage cupboard located next to the master bedroom. The property has a large attic which has been boarded, providing an excellent storage area plus potential for conversion.

Outside, the property offers off-road parking to the front. There is side access leading to the rear garden which offers a wrap-around patio, perfect for al fresco dining. The rest of the garden is laid to lawn.

**Location:** The area surrounding Vernon Park Road, offers a range of amenities ideal for families and professionals alike. Within walking



Vernon Park Road, Worcester  
Ground Floor

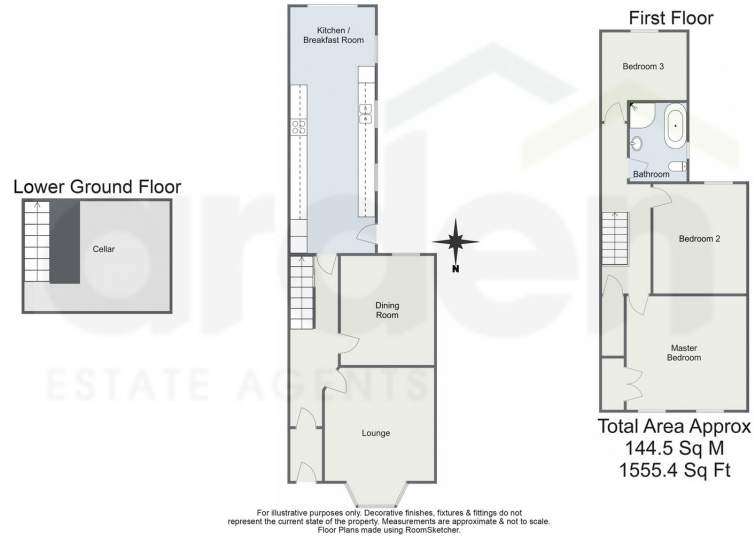

- Period Property
- Side Access
- Open Plan Kitchen Breakfast Room
- Off-Road Parking Room
- Popular Location
- Well Maintained

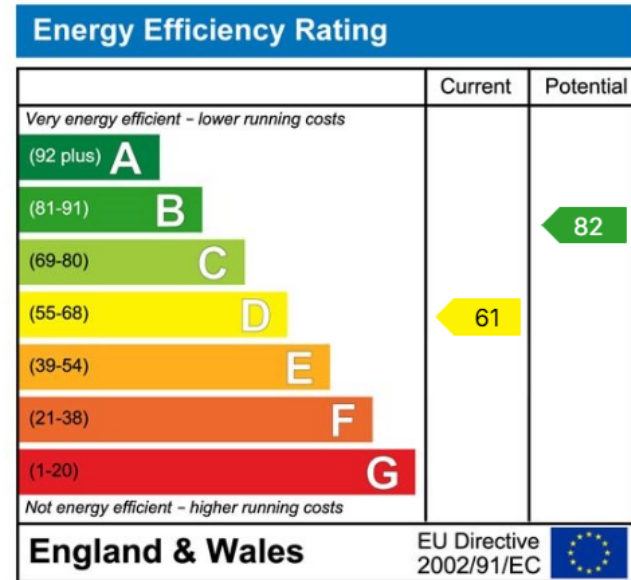

For more information on this house or to arrange a viewing please call the office on:

**01905 958 290**

Alternatively, you can scan the QR to view all of the details of this property online.

