



The logo for Arden Estate Agents features a stylized green house icon above the word "arden" in a bold, white, sans-serif font. Below "arden" is the text "ESTATE AGENTS" in a smaller, white, sans-serif font.

arden  
ESTATE AGENTS

It's who  
you move  
with.



# Plymouth Close, Headless Cross, Redditch, B97 4NP

£210,000

🛏️ 2 🚿 1 🛋️ 1



- No Onward Chain
- Retirement Bungalow for Over 55's
- Garage, Driveway and Additional Resident Parking
- Additional Benefits with Plymouth Court
- Private Rear Garden
- Guest Suite, Owners Lounge and Dining Area
- On Site Staff 24/7





This neatly presented two-bedroom semi-detached bungalow for over 55's is being sold with no upward chain offers off-road parking, a single garage and a delightful private rear garden. Located in the popular area of Headless Cross, Redditch.

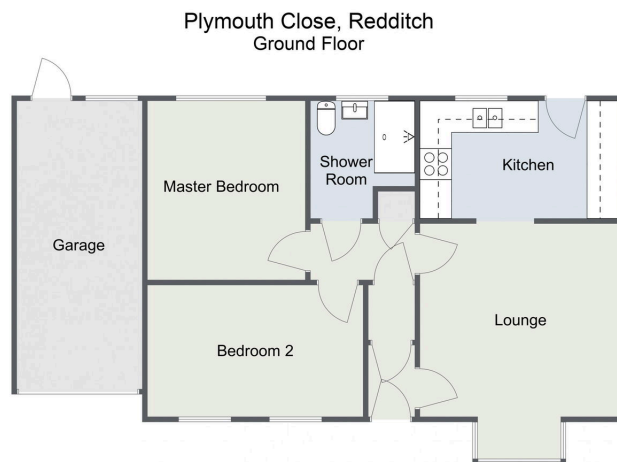

Total Area Approx  
68.6 Sq M  
738.40 Sq Ft

For illustrative purposes only. Decorative finishes, fixtures & fittings do not represent the current state of the property. Measurements are approximate & not to scale. Floor Plans made using RoomSketcher.

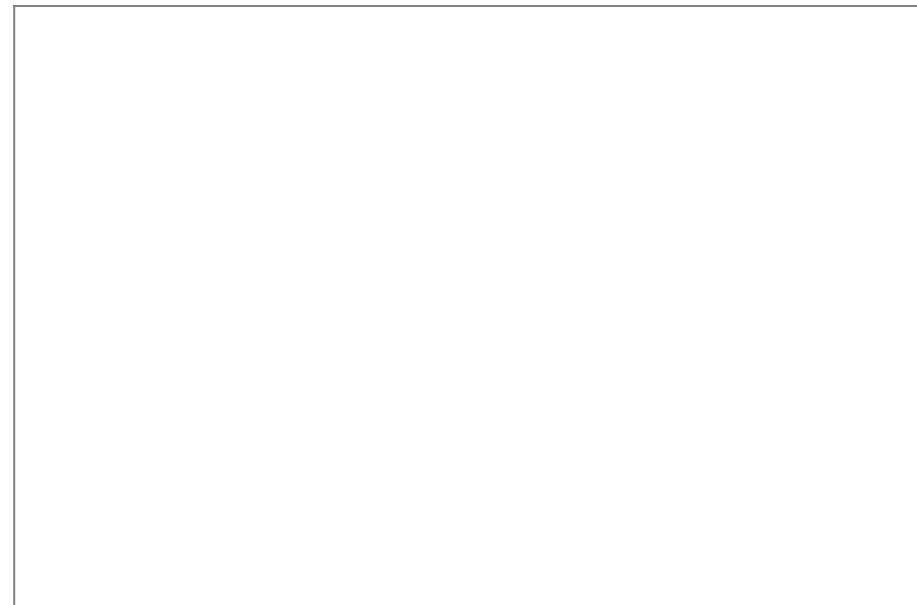

For more information on this house or to arrange a viewing please call the office on:

**01527 540 654**

Alternatively, you can scan the QR to view all of the details of this property online.



**arden**  
ESTATE AGENTS