





St. Michaels Road, Worcester, WR3 7PD

£315,000

3 1 1





A gorgeous extended semi detached family home situated in the heart of Claines, with excellent catchment area for schools. This property has been fully renovated and tastefully decorated throughout with high quality modern fixture and fittings. The property in brief comprises; open plan kitchen/dining room, lounge, w/c, three bedrooms and bathroom. Viewing is recommended to appreciate the size and location.

The ground floor opens into a cozy lounge, perfect for relaxing or entertaining. The lounge features a lovely log burner as the focal point, creating a warm ambience. Moving further into the property, you'll find the stylish and spacious kitchen/diner, complete with contemporary finishes, a central island, bi-fold doors to the garden. The kitchen features built in appliances which include an oven and grill, positioned at height, induction hob, modern extractor fan, dishwasher, washing machine and sink integrated into the island. The island also acts as a breakfast bar, perfect for informal dining. The whole area is designed for both cooking and gathering, providing a bright, inviting space for family meals or entertaining guests. A convenient WC on this level adds to the home's practicality.

Upstairs, the first floor offers three comfortable bedrooms. The master bedroom is generously sized, creating a peaceful retreat for relaxation with built in wardrobes for added convenience. Bedrooms two and three both feature built in wardrobes also. They are them ideal for family members, guests, or even a home office setup. The fully renovated bathroom has been fully tiled and includes a 'P' shape bath with overhead shower, sink and toilet.

Outside, the garden can be accessed from both the front of the property and the kitchen, offers a patio area which is perfect for al-fresco dining. The rest of the garden is laid to lawn and also features vegetable patches.

This newly refurbished home on St Michaels Road is perfect for those seeking a blend of updated interiors, functional space, and a great location. Ready to impress, this property is a fantastic opportunity to settle into a welcoming, renovated home. Don't miss out on making it yours!



St Michaels Road, Worcester  
Ground Floor

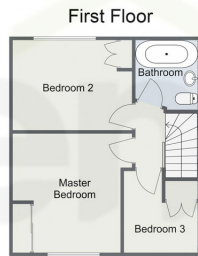
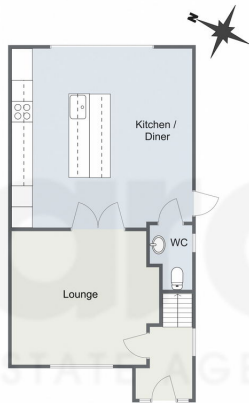

Total Area Approx  
81.2 Sq M  
874.0 Sq Ft

For illustrative purposes only. Decorative finishes, fixtures & fittings do not represent the current state of the property. Measurements are approximate & not to scale. Floor Plans made using RoomSketcher.

- Open Plan Kitchen Diner
- Renovated Throughout
- Modern Bathroom
- Log Burner
- Downstairs WC
- Popular Location

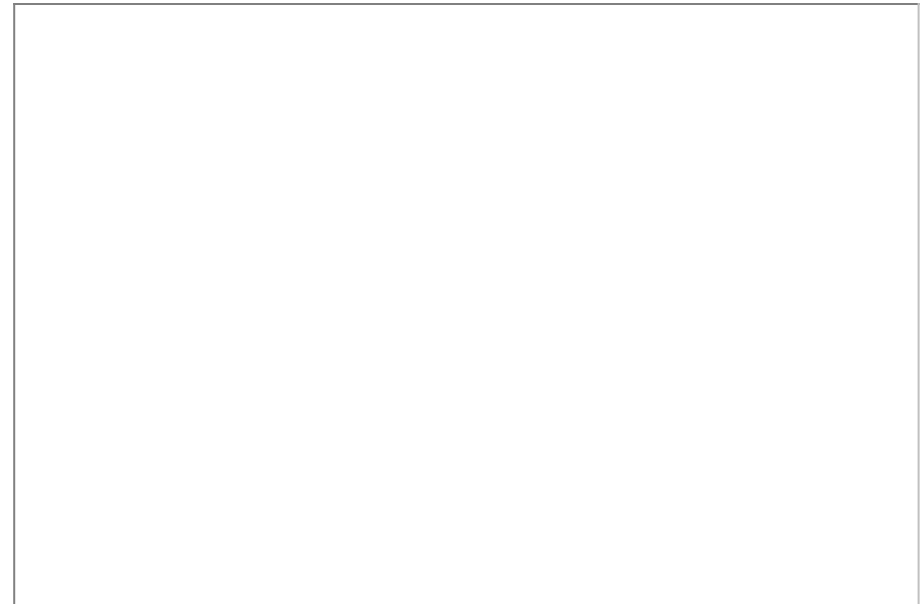

For more information on this house or to arrange a viewing please call the office on:

**01905 958 290**

Alternatively, you can scan the QR to view all of the details of this property online.



**arden**  
ESTATE AGENTS