





# Pegasus Way, Rednal, Birmingham, B45 8JQ

Offers Over £280,000

3 2 1





- Three Bedrooms
- Open Plan Lounge / Kitchen and Diner
- Downstairs WC and Utility
- Family Bathroom
- En-Suite to Master Bedroom
- Rear Garden
- Two Allocated Parking Spaces
- Entrance Hall with Storage Space



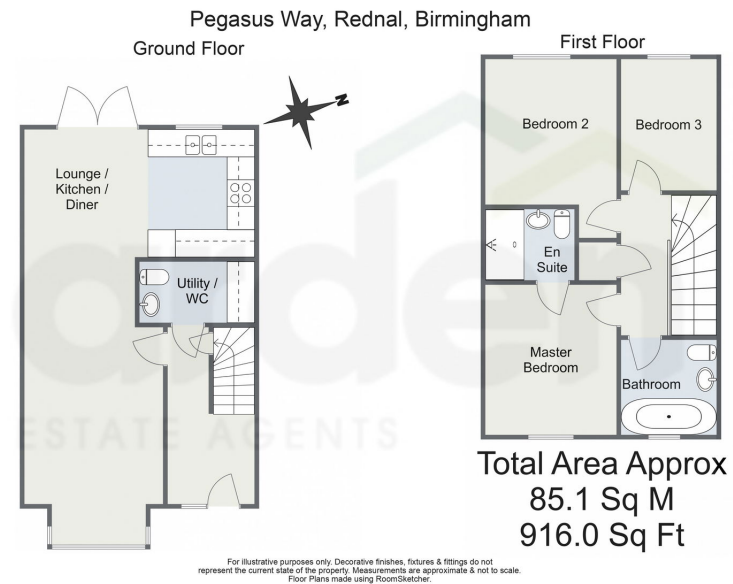

Introducing this three-bedroom terraced property boasting the convenience of two allocated spaces, an open-plan ground floor, a downstairs WC/utility and a charming rear garden nestled in the desirable location of Rednal.

10/10/24, 1:55 PM

Energy performance certificate (EPC) - Find an energy certificate - GOV.UK

Energy performance certificate (EPC)		
10 Pegasus Way Rednal B63 5JZ	Energy rating <b>C</b>	Valid until: 28 May 2034 Certificate number: 9834-5423-0308-0014-8222
Property type	Mid-terrace house	
Total floor area	94 square metres	

**Rules on letting this property**

Properties can be let if they have an energy rating from A to E.

You can read [guidance for landlords on the regulations and exemptions](#)  
[https://www.gov.uk/guidance/landlords-who-are-letting-property-current-energy-efficiency-standards-landlord-guidance](#)

**Energy rating and score**

This property's energy rating is C. It has the potential to be B.

[See how to improve this property's energy efficiency.](#)

The graph shows this property's current and potential energy rating.

**Properties get a rating from A (best) to G (worst) and a score.** The better the rating and score, the lower your energy bills are likely to be.

For properties in England and Wales:  
the average energy rating is D  
the average energy score is 60

For more information on this house or to arrange a viewing please call the office on:  
**0121 453 4349**

Alternatively, you can scan the QR to view all of the details of this property online.

