



Malvern Road, Worcester, WR2 4NT

£385,000

4 1 2



Situated on the desirable Malvern Road in Worcester, this charming four bedroom family home offers versatile living space. Perfectly designed for modern family life, this property boasts four bedrooms, outdoor amenities, and a convenient location close to local services and schools.

On the ground floor, the property welcomes you into a spacious open-plan lounge and dining area, providing the perfect setting for relaxation and entertainment. The large layout creates a bright, open atmosphere, ideal for both family gatherings and quiet evenings. The kitchen, situated just off the dining area, is thoughtfully designed with modern fixtures and ample storage space. A convenient downstairs WC is located near the entrance, adding extra practicality to the home.

The first floor features four generously sized bedrooms. The master bedroom is spacious and peaceful, offering a comfortable retreat. Bedrooms 2, 3, and 4 are also well-sized, making them ideal for children, guests, or a home office. A modern family bathroom with a full suite is easily accessible from all bedrooms.

The property also benefits from outdoor amenities, including a private garage and a "lean-to" area that provides additional storage or space for gardening equipment. This home offers the perfect blend of indoor comfort and outdoor convenience.

With its fantastic location, spacious layout, and modern conveniences, this home is ideal for families looking for a property that caters to their everyday needs while offering a warm and welcoming environment. Don't miss the opportunity to view this wonderful home. Contact us today to arrange a viewing!

Location: This property offers an incredible location that is perfect for those who seek peace and tranquillity, while being close to the city centre. With easy access to Worcester city centre and Pitmaston Park, you'll be able to find the perfect balance between quiet living and city life. The town centre is full of cultural attractions, including art galleries, theatres, and live music. You can also explore the city's rich history through its museums and historical walks. The River Severn flowing through the city provides a great backdrop for serene



Malvern Road, Worcester
Ground Floor

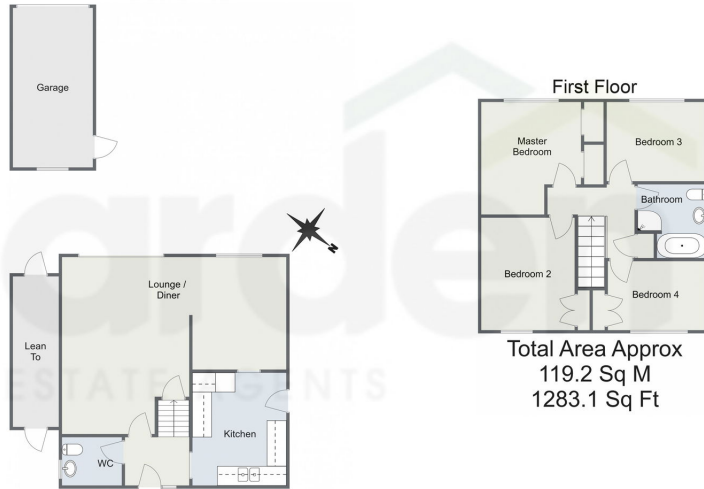

Total Area Approx
119.2 Sq M
1283.1 Sq Ft

For illustrative purposes only. Decorative finishes, fixtures & fittings do not represent the current state of the property. Measurements are approximate & not to scale. Floor Plans made using RoomSketcher.

- Popular Location
- Open Plan Living
- Low Maintenance Garden
- Modern Kitchen
- Updated Bathroom
- Ample Parking

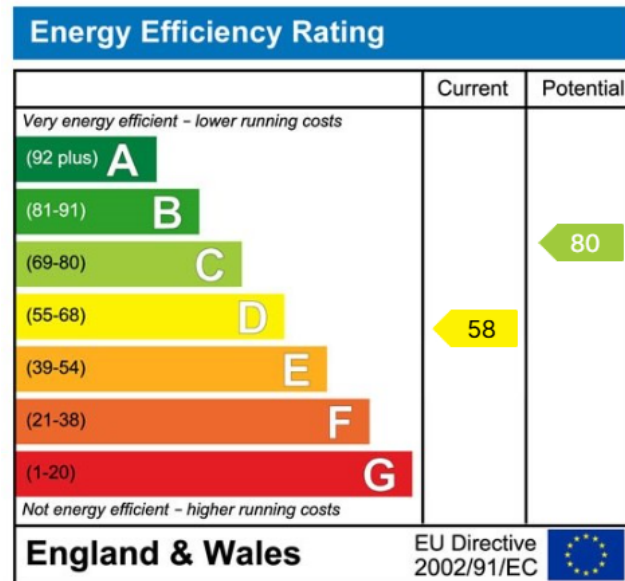

For more information on this house or to arrange a viewing please call the office on:

01905 958 290

Alternatively, you can scan the QR to view all of the details of this property online.

