



The logo for Arden Estate Agents, featuring a green house icon above the word "arden" in a bold, white, sans-serif font. Below "arden" is the text "ESTATE AGENTS" in a smaller, white, sans-serif font.

arden
ESTATE AGENTS

It's who
you move
with.

Wolverton Road, Rednal, Birmingham, B45 8RN

£200,000

3 1 1



- Three Bedrooms
- Conservatory
- Rear Garden
- Secured Porch
- Open Plan Lounge / Kitchen and Diner
- Family Bathroom
- Off Road Parking
- Entrance Hall





Wolverton Road, Rednal, Birmingham
Ground Floor

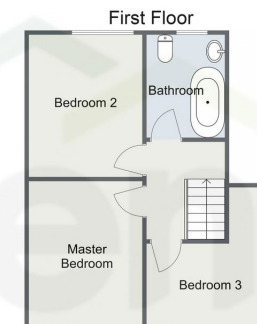
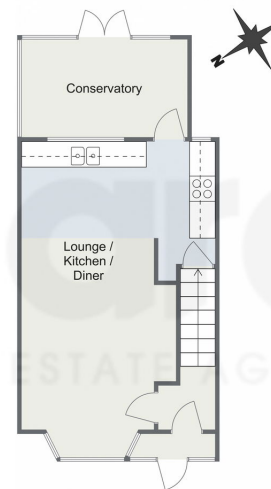

Total Area Approx
76.6 Sq M
824.5 Sq Ft

For illustrative purposes only. Decorative finishes, fixtures & fittings do not represent the current state of the property. Measurements are approximate & not to scale. Floor Plans made using RoomSketcher.

A well-presented three-bedroom terraced home in Rednal, Birmingham, featuring an open-plan lounge, kitchen, and dining area, a conservatory, family bathroom, rear garden, and off-road parking.

10/20/24, 11:33 AM Energy performance certificate (EPC) - Find an energy certificate - GOV.UK

Energy performance certificate (EPC)	
54 Wolverton Road Rednal Birmingham B95 8PW	Energy rating: D Valid until: 22 July 2034 Certificate number: 2273-3048-6203-6164-2204
Property type: Mid-terrace house	Total floor area: 66 square metres

Rules on letting this property

Properties can be let if they have an energy rating from A to E.

You can read [guidance for landlords on the regulations and exemptions](https://www.gov.uk/guidance/landlords-on-the-regulations-and-exemptions).

<https://www.gov.uk/guidance/landlords-on-the-regulations-and-exemptions#energy-efficiency-standards-landlord-guidance>.

Energy rating and score

This property's energy rating is D. It has the potential to be B.

[See how to improve this property's energy efficiency.](#)

The graph shows this property's current and potential energy rating.

Properties get a rating from A (best) to G (worst) and a score. The better the rating and score, the lower your energy bills are likely to be.

For properties in England and Wales:
the average energy rating is D
the average energy score is 60

<https://find-energy-certificates.service.gov.uk/energy-certificates/2273-3048-6203-6164-2204/print.htm>

1/4

For more information on this house or to arrange a viewing please call the office on:

0121 453 4349

Alternatively, you can scan the QR to view all of the details of this property online.

