



ESTATE AGENTS

It's who
you move
with.

Surman Street, Worcester, WR1 1HL

£480,000

🛏️ 2 🚿 2 🚗 2



Are you ready to live in a gorgeous penthouse overlooking the city, with far reaching views and a private terrace? Then this is the perfect property for you! We highly recommend booking a viewing on this unique and immaculately presented property!

The entrance to the property is via a lift which brings you right into the property itself! From the lift, you are greeted by a dining hall that flows seamlessly into the expansive living room. The lounge is light and bright, thanks to the gorgeous floor to ceiling windows, complete with remote control window blinds, overlooking the terrace. The neutral décor is in keeping with the rest of the property. The lounge opens up to a large roof terrace, perfect for enjoying the views, outdoor dining, or entertaining. Next to the lift, the property has a good sized storage cupboard, which includes a second fridge/freezer, adding to the overall convenience of the home.

The apartment boasts two well-proportioned double bedrooms, both featuring wardrobes which are included in the sale. Bedroom two is located near the main bathroom that includes a walk in shower, a sink and toilet. The bathroom has been fully tiled to a high standard. While bedroom one has the en-suite, also fully tiled, which features a roll top bath with shower attachment, a toilet and sink.

The kitchen, situated off the inner hall, is decorated in tones in keeping with the rest of the property. Equipped with both base and eye level units, granite splashbacks, and granite worktops, all providing ample preparation space for your cooking needs. The breakfast bar with space for two stools is perfect for informal dining or socialising with guests while cooking. The whole kitchen has been finished to a high standard with built in appliances to include a Quooker filtration and boiling water tap, fridge freezer, dishwasher, washing machine, drier, induction hob, extractor fan, grill and double oven.

Outside, the gorgeous wrap around terrace offers far reaching views and a great space to enjoy warmer days. The current vendors have a hot tub, which is included in the sale along with the outdoor furniture, perfect for outdoor hosting. The gazebo with an electric opening roof adds to the overall space. The property also offers two allocated parking spaces.



Surman Street, Worcester

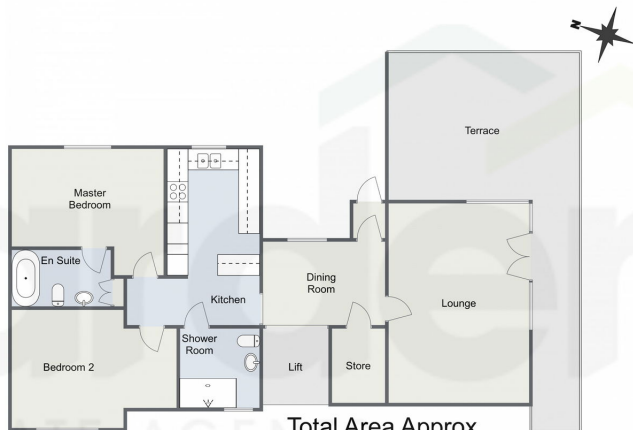

Total Area Approx
125.3 Sq M
1348.7 Sq Ft

For illustrative purposes only. Decorative finishes, fixtures & fittings do not represent the current state of the property. Measurements are approximate & not to scale. Floor Plans made using RoomSketcher.

- Lift Into The Penthouse
- Gorgeous Decor Throughout
- Wrap Around Roof Terrace
- Close to City Centre
- Allocated Parking
- Great Views



Energy Efficiency Rating

	Current	Potential
<i>Very energy efficient - lower running costs</i>		
(92 plus) A		
(81-91) B	82	82
(69-80) C		
(55-68) D		
(39-54) E		
(21-38) F		
(1-20) G		
<i>Not energy efficient - higher running costs</i>		
England & Wales	EU Directive 2002/91/EC	

For more information on this house or to arrange a viewing please call the office on:

01905 958 290

Alternatively, you can scan the QR to view all of the details of this property online.

