



Caban Close, Northfield, Birmingham, B31 1TU

Offers Over £125,000

🛏 1 🚿 1 🚗 1



- One Double Bedroom
- Modern Open Plan Lounge and Kitchen
- Family Bathroom
- Allocated Parking Space
- Entrance Hall with Storage
- Secured Communal Hall



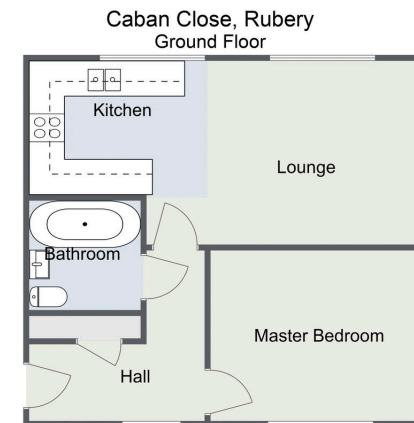
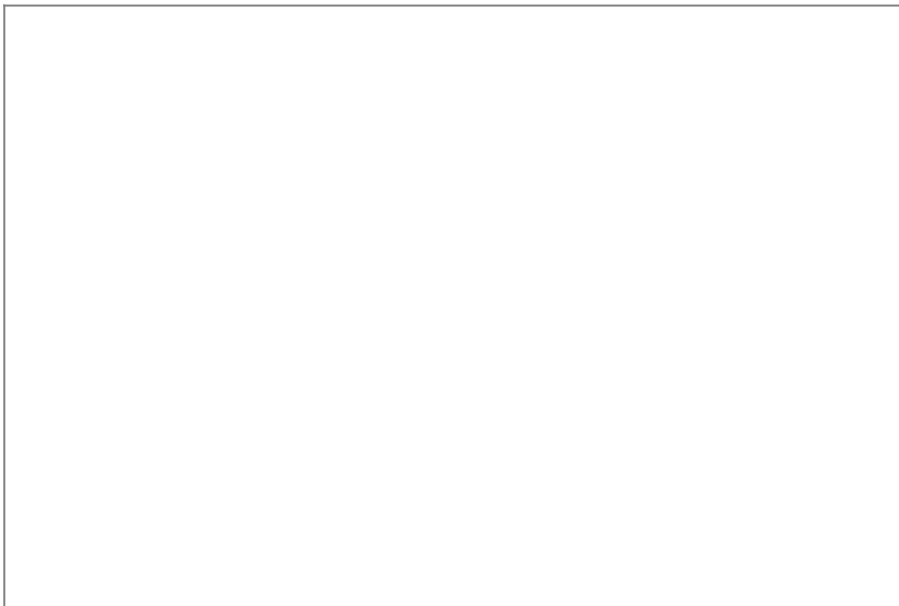

Total Area Approx
44.8 Sq M
482.22 Sq Ft

For illustrative purposes only. Decorative finishes, fixtures & fittings do not represent the current state of the property. Measurements are approximate & not to scale. Floor Plans made using RoomSketcher.

NO UPWARD CHAIN

Presenting a one bedroom, second floor apartment offered with no upward chain, modern open plan lounge and kitchen, allocated parking space and a family bathroom situated in Northfield, Birmingham.

09/10/2024, 10:22 Energy performance certificate (EPC) - Find an energy certificate - GOV.UK

Energy performance certificate (EPC)																																			
Apartment 5 Caban Close BIRMINGHAM B21 1TU	Energy rating C	Valid until 8 October 2024	Certificate number 2189-8223-5658-6311-6119																																
Property type Total floor area	Top-floor flat 40 square metres																																		
Rules on letting this property																																			
Properties can be let if they have an energy rating from A to E.																																			
You can read guidance for landlords on the regulations and exemptions (https://www.gov.uk/guidance/landlords-who-are-letting-property), minimum energy efficiency standard (landlord) (https://www.gov.uk/guidance/minimum-energy-efficiency-standard-landlord).																																			
Energy rating and score																																			
This property's energy rating is C. It has the potential to be C.		The graph shows this property's current and potential energy rating.																																	
See how to improve this property's energy efficiency.		Properties get a rating from A (best) to G (worst) and a score . The better the rating and score, the lower your energy bills are likely to be.																																	
<table border="1"> <thead> <tr> <th>Score</th> <th>Energy rating</th> <th>Current</th> <th>Potential</th> </tr> </thead> <tbody> <tr> <td>92-100</td> <td>A</td> <td></td> <td></td> </tr> <tr> <td>81-91</td> <td>B</td> <td></td> <td></td> </tr> <tr> <td>69-80</td> <td>C</td> <td>←</td> <td>→</td> </tr> <tr> <td>55-68</td> <td>D</td> <td></td> <td></td> </tr> <tr> <td>39-54</td> <td>E</td> <td></td> <td></td> </tr> <tr> <td>21-38</td> <td>F</td> <td></td> <td></td> </tr> <tr> <td>1-20</td> <td>G</td> <td></td> <td></td> </tr> </tbody> </table>		Score	Energy rating	Current	Potential	92-100	A			81-91	B			69-80	C	←	→	55-68	D			39-54	E			21-38	F			1-20	G			For properties in England and Wales: the average energy rating is D the average energy score is 60	
Score	Energy rating	Current	Potential																																
92-100	A																																		
81-91	B																																		
69-80	C	←	→																																
55-68	D																																		
39-54	E																																		
21-38	F																																		
1-20	G																																		

For more information on this house or to arrange a viewing please call the office on:
0121 453 4349

Alternatively, you can scan the QR to view all of the details of this property online.

