



For Sale
arden
ESTATE AGENTS
0121 453 4349 arden@arden.co.uk

arden
ESTATE AGENTS

It's who
you move
with.

Ryde Park Road, Rednal, Birmingham, B45 8RG

£240,000

3 1 2



- Three Bedroom
- Kitchen with Integrated Appliances
- Shower Room
- Off Road Parking
- Lounge with a Featured Fireplace
- Dining Room
- Rear Garden
- Garage



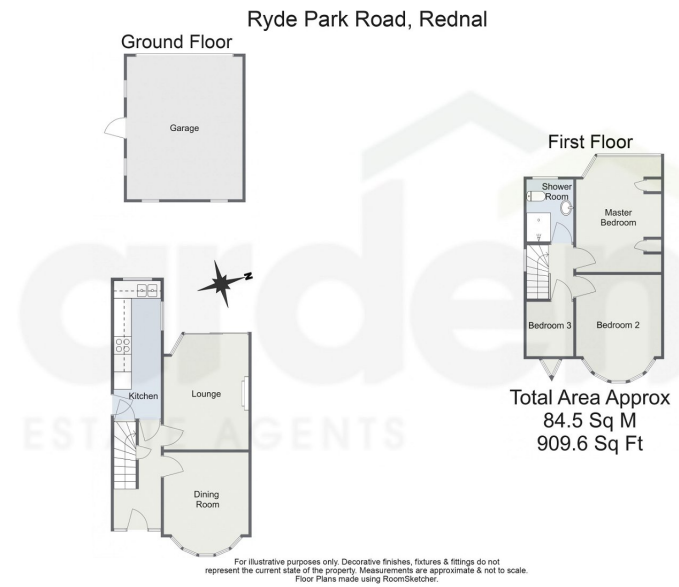

A well kept three-bedroom semi-detached property featuring a cosy lounge, second reception room, kitchen with integrated appliances, shower room, and a rear garden with a garage, all situated in Rednal, Birmingham. This residence promises a blend of functionality and charm in a sought-after location.

5/13/24, 2:28 PM Energy performance certificate (EPC) - Find an energy certificate - GOV.UK

Energy performance certificate (EPC)

Energy rating	Valid until	9 May 2034
E	Certificate number	9102-3817-2295-8474-8204

Property type: Semi-detached house
Total floor area: 66 square metres

Rules on letting this property

Properties can be let if they have an energy rating from A to E.

You can read [guidance for landlords on the regulations and exemptions](https://www.gov.uk/guidance/domestic-private-rented-property-minimum-energy-efficiency-standard-landlord) (<https://www.gov.uk/guidance/domestic-private-rented-property-minimum-energy-efficiency-standard-landlord>).

Energy rating and score

This property's energy rating is E. It has the potential to be B.

[See how to improve this property's energy efficiency.](#)

The graph shows this property's current and potential energy rating.

Properties get a rating from A (best) to G (worst) and a score. The better the rating and score, the lower your energy bills are likely to be.

For properties in England and Wales:
the average energy rating is D
the average energy score is 60

<https://find-energy-certificates.service.gov.uk/energy-certificates/1102-3817-2295-8474-8204?print=true>

1/4

For more information on this house or to arrange a viewing please call the office on:

0121 453 4349

Alternatively, you can scan the QR to view all of the details of this property online.

