



2 Hewell Road, Barnt Green, Birmingham, B45 8NE

£475,000

3 1 2



Summary

A traditional three double bedroom semi-detached home adorned with character and period features throughout, located in heart of Barnt Green. This residence is offered with a driveway, two reception rooms, kitchen, and low-maintenance rear garden, but it also gives purchasers the option to "put on your own stamp."

Description

The property is approached via a driveway providing off road parking for two vehicles.

Once inside, the entry hallway provides doorways to the lounge and sitting room, both with traditional fireplaces, and kitchen/diner with external door to the rear garden.

The bedroom quarters are accessible from the stairs leading to the first floor landing, with each room featuring double beds, and a family bathroom.

Outside

The residence enjoy a low maintenance rear garden, with paved patio and fenced boundaries.

Lounge - 3.93m x 3.64m (12'10" x 11'11") max

Sitting Room - 4.54m x 3.64m (14'10" x 11'11") max

Kitchen/Diner - 4.44m x 3.94m (14'6" x 12'11")

Stairs To First Floor Landing

Master Bedroom - 4.44m x 3.94m (14'6" x 12'11")

Bedroom 2 - 3.83m x 3.66m (12'6" x 12'0") max

Bedroom 3 - 4.01m x 2.81m (13'1" x 9'2")

Bathroom - 2.29m x 1.61m (7'6" x 5'3")





- Three Double Bedrooms
- Two Reception Rooms
- Driveway
- Prime Location
- Kitchen
- Low Maintenance Rear Garden
- Character and Period Features Throughout
- Option to 'Put Own Stamp' on the Property

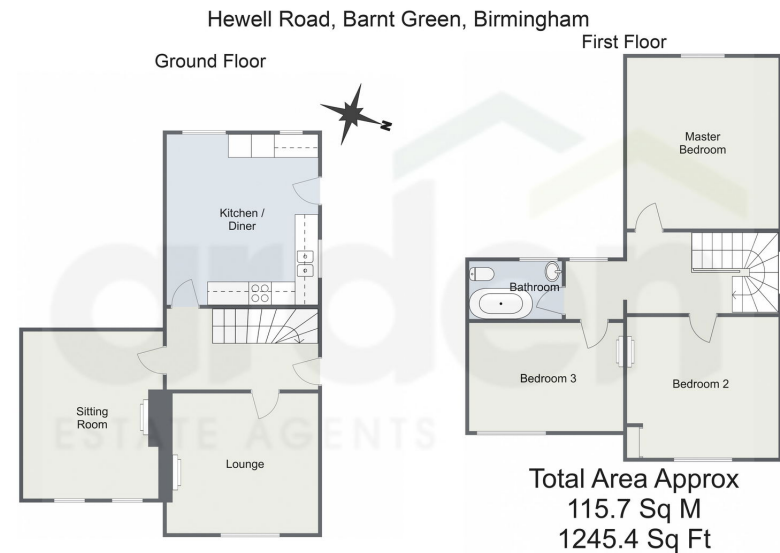

For illustrative purposes only. Decorative finishes, fixtures & fittings do not represent the current state of the property. Measurements are approximate & not to scale. Floor plans made using RoomSketcher.

For more information on this house or to arrange a viewing please call the office on:

0121 447 8300

Alternatively, you can scan the QR to view all of the details of this property online.

