



Bartley Crescent, Northfield, Birmingham, B31 1UU

£280,000

3 2 1



- Three Bedrooms
- Spacious Lounge
- Modern Kitchen/Diner
- Downstairs WC
- Conservatory
- Ensuite to Master Bedroom and Family Bathroom
- Rear Garden
- Off Road Parking with a Garage





Bartley Crescent, Birmingham

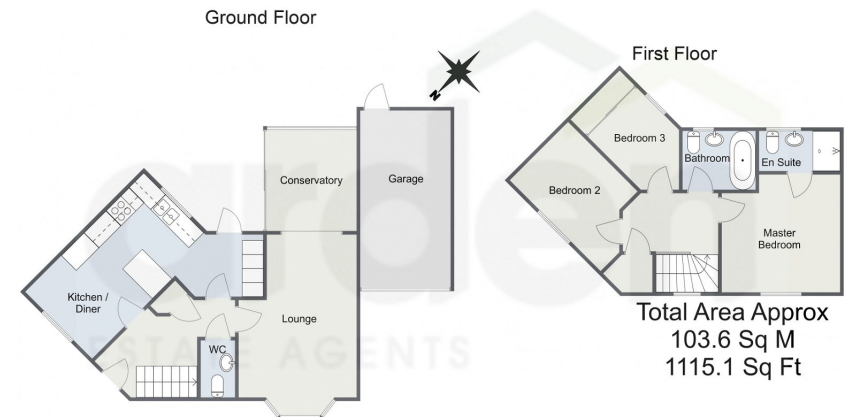

For illustrative purposes only. Decorative finishes, fixtures & fittings do not represent the current state of the property. Measurements are approximate & not to scale. Floor Plans made using RoomSketcher.

Introducing a beautifully finished three-bedroom semi-detached family home in the desirable area of Northfield, Birmingham. This inviting residence features a spacious lounge with a bay window, a bright conservatory, and a modern kitchen/diner. Additional amenities include a convenient downstairs WC, an ensuite to the master bedroom, a family bathroom, a well-maintained rear garden, and off-road parking with a garage.

For more information on this house or to arrange a viewing please call the office on:

0121 453 4349

Alternatively, you can scan the QR to view all of the details of this property online.

