



# Heather Drive, Rednal, Birmingham, B45 9RA

£320,000

3 1 1



- Three Bedrooms
- Kitchen
- Rear Garden
- Secured Porch
- Lounge/Diner
- Family Bathroom
- Off Road Parking with Garage
- Close to Amenities



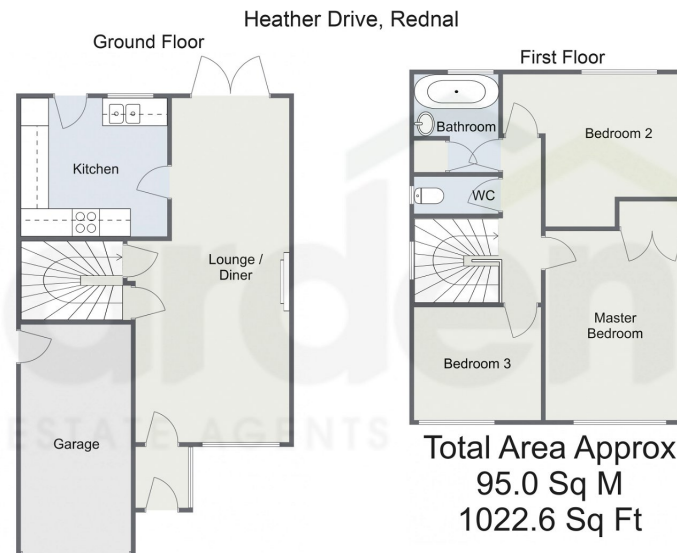

For illustrative purposes only. Decorative finishes, fixtures & fittings do not represent the current state of the property. Measurements are approximate & not to scale. Floor plans made using RoomSketcher.

Discover this three-bedroom detached home nestled in the charming locale of Rednal, Birmingham. Boasting convenient off-road parking alongside a garage, the residence welcomes you into a spacious lounge/diner adorned with a captivating feature fireplace. Seamlessly connected is the modern kitchen, complemented by a well-appointed family bathroom. Step outside to the tranquil rear garden, completing this delightful abode.

22/04, 9:57 AM Energy performance certificate (EPC) - Find an energy certificate - GOV.UK

Energy performance certificate (EPC)																																	
59 Heather Drive Rednal B37 7JH BPD: 89A	<table border="1"> <tr> <td>Energy rating</td> <td>Valid until</td> <td>19 February 2034</td> </tr> <tr> <td style="text-align: center; font-size: 2em;"><b>D</b></td> <td>Certificate number</td> <td>4000-5101-0122-2201-3243</td> </tr> </table>	Energy rating	Valid until	19 February 2034	<b>D</b>	Certificate number	4000-5101-0122-2201-3243																										
Energy rating	Valid until	19 February 2034																															
<b>D</b>	Certificate number	4000-5101-0122-2201-3243																															
Property type	Detached house																																
Total floor area	82 square metres																																
<b>Rules on letting this property</b>																																	
Properties can be let if they have an energy rating from A to E.																																	
You can read <a href="https://www.gov.uk/guidance/domestic-private-rented-property-minimum-energy-efficiency-standards-landlords">guidance for landlords on the regulations and exemptions</a> <a href="https://www.gov.uk/guidance/domestic-private-rented-property-minimum-energy-efficiency-standards-landlords">https://www.gov.uk/guidance/domestic-private-rented-property-minimum-energy-efficiency-standards-landlords</a>																																	
<b>Energy rating and score</b>																																	
This property's energy rating is D. It has the potential to be B.  <a href="#">See how to improve this property's energy efficiency.</a>	The graph shows this property's current and potential energy rating.  <b>Properties get a rating from A (best) to G (worst) and a score.</b> The better the rating and score, the lower your energy bills are likely to be.  For properties in England and Wales:  the average energy rating is D the average energy score is 60																																
<table border="1"> <thead> <tr> <th>Score</th> <th>Energy rating</th> <th>Current</th> <th>Potential</th> </tr> </thead> <tbody> <tr><td>92+</td><td>A</td><td></td><td></td></tr> <tr><td>81-91</td><td>B</td><td></td><td></td></tr> <tr><td>69-80</td><td>C</td><td></td><td></td></tr> <tr><td>55-68</td><td>D</td><td></td><td></td></tr> <tr><td>39-54</td><td>E</td><td></td><td></td></tr> <tr><td>21-38</td><td>F</td><td></td><td></td></tr> <tr><td>1-20</td><td>G</td><td></td><td></td></tr> </tbody> </table>	Score	Energy rating	Current	Potential	92+	A			81-91	B			69-80	C			55-68	D			39-54	E			21-38	F			1-20	G			
Score	Energy rating	Current	Potential																														
92+	A																																
81-91	B																																
69-80	C																																
55-68	D																																
39-54	E																																
21-38	F																																
1-20	G																																

https://find-energy-certificates.service.gov.uk/energy-certificates/4000-5101-0122-2201-3243?print=true

1/4

For more information on this house or to arrange a viewing please call the office on:  
**0121 453 4349**

Alternatively, you can scan the QR to view all of the details of this property online.

