



ESTATE AGENTS

It's who
you move
with.

Victoria Institute, Worcester, WR1 1DF

£215,000

1 1 1



Summary: Arden Estates are delighted to offer a rare chance to purchase a piece of history. Dating back to 1896 and converted in 2001, this beautiful apartment is located in the prestigious and historical Grade II listed Victoria Institute. Adorned by original features and a spiral staircase located within the turret, the architectural design sets this property apart. Offering a distinctive living experience for those seeking a unique home. The tall ceilings, coupled with copious large windows ensure a space filled by natural light. Whilst the views of Worcester City's skyline appear as though they are artwork within the property, framed by the windows. With its own private balcony and under cover parking, this luxurious property is bound to capture your heart.

Description: As you step into this exquisite property through the front door, you'll be greeted by the hallway and its stunning archway, comprised of multiple windows and French doors leading to the kitchen diner. The abundance of natural light floods the space creating a warm and inviting ambiance, setting the tone for the rest of the home. The hallway not only serves as a welcoming entrance but also provides access to practical features such as a storage cupboard, w/c, and the lounge, as well as seamlessly flowing into the kitchen diner. The w/c has been neutrally decorated in keeping with the rest of the apartment. This neutral décor throughout ensures that your focus remains on the striking architecture and design elements.

The kitchen diner is encompassed by windows on three of its walls offering nearly panoramic views of the Institute's surroundings. The kitchen is designed with functionality in mind, providing ample countertop space for cooking enthusiasts. The U-shaped layout not only adds to the aesthetic appeal but also ensures plenty of storage within the cabinets. It also allows for a dining area, perfect for hosting. The integrated appliances further enhance the convenience and efficiency of this kitchen, offering a fridge freezer, washing machine, oven, hob, and extractor fan. The kitchen architecture boasts a feature arch and vaulted ceiling so whether you are a professional chef or simply enjoy spending time in the kitchen, this kitchen diner provides the perfect blend of style, functionality, and breath taking views.

The lounge serves as the centre piece of the apartment, offering a



Sansome Walk, Worcester

2.

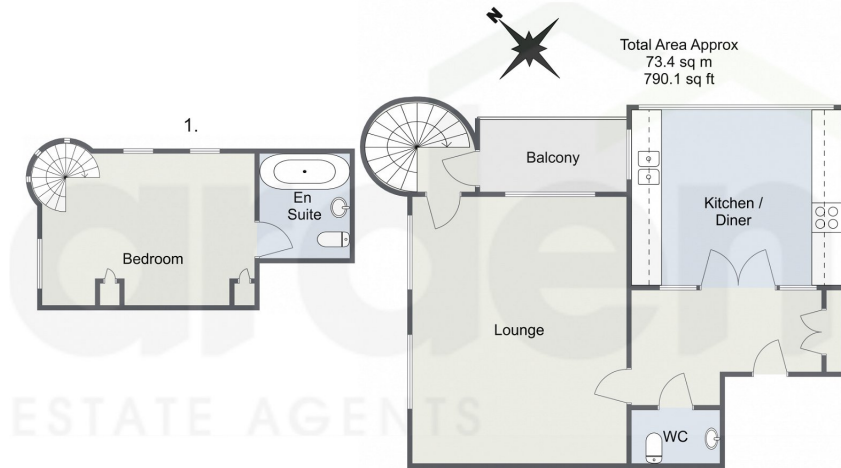

For illustrative purposes only. Decorative finishes, fixtures & fittings do not represent the current state of the property. Measurements are approximate & not to scale. Floor Plans made using RoomSketcher.

- Original Victorian features
- Private balcony
- Spiral staircase within building's turret
- Underground car parking
- Apartment living
- Spacious

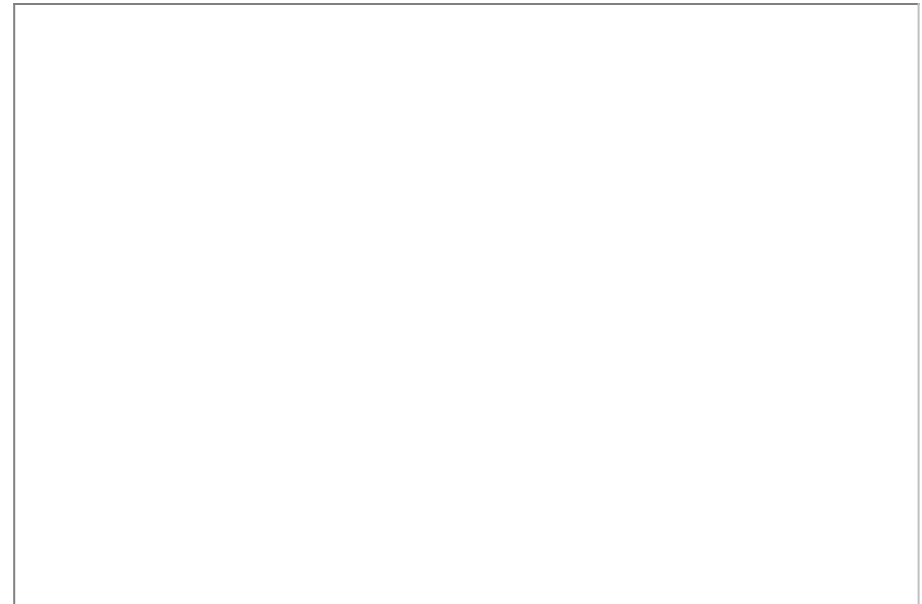

For more information on this house or to arrange a viewing please call the office on:

01905 958 290

Alternatively, you can scan the QR to view all of the details of this property online.



arden
ESTATE AGENTS