



Corinne Close, Rednal, Birmingham, B45 8EJ

Offers Over £210,000

🛏️ 2 🚿 1 🚻 1



- Two Bedrooms
- Modern Kitchen
- Secured Porch
- Off Road Parking
- Lounge/Diner
- Family Bathroom
- Rear Garden
- Garage



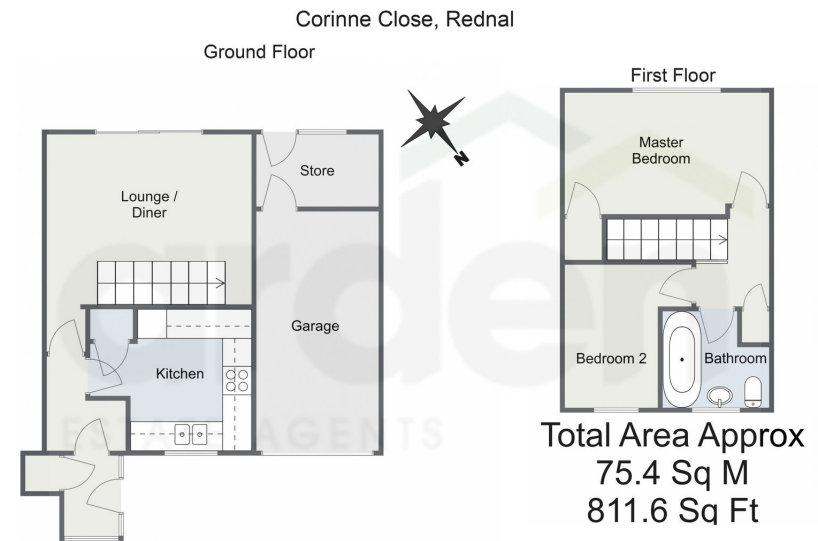

For illustrative purposes only. Decorative finishes, fixtures & fittings do not represent the current state of the property. Measurements are approximate & not to scale. Floor Plans made using RoomSketcher.

Introducing a well-presented two-bedroom, end off terraced property in Rednal, Birmingham. This charming home offers off-road parking with a garage, a lounge/diner, a modern kitchen, a convenient storage area, a family bathroom, and a delightful rear garden.

Energy performance certificate (EPC)

44 Corinne Close Rednal B69 6EJ	Energy rating C	Valid until 19 July 2024
Certificate number 2720-9333-0370-3005-1433		

Property type: Semi-detached house
Total floor area: 55 square metres

Rules on letting this property

Properties can be let if they have an energy rating from A to E.

You can read [guidance for landlords on the regulations and exemptions](https://www.gov.uk/guidance/landlords-on-the-requirements-and-exemptions).
<https://www.gov.uk/guidance/landlords-on-the-requirements-and-exemptions#energy-efficiency-standards-landlord-guidance>.

Energy rating and score

This property's energy rating is C. It has the potential to be B.

[See how to improve this property's energy efficiency.](#)

The graph shows this property's current and potential energy rating.

Properties get a rating from A (best) to G (worst) and a score. The better the rating and score, the lower your energy bills are likely to be.

For properties in England and Wales:
the average energy rating is D
the average energy score is 50

For more information on this house or to arrange a viewing please call the office on:

0121 453 4349

Alternatively, you can scan the QR to view all of the details of this property online.

