



ESTATE AGENTS

It's who
you move
with.

Cotteridge Road, Cotteridge , Birmingham, B30 3AZ

£230,000

🛏️ 2 🚿 1 🚗 1



- Two Bedrooms
- Dining Room
- Contemporary Family Bathroom
- Secured Porch
- Spacious Lounge
- Modern Kitchen
- Rear Garden
- Close to Amenities





Presenting a charming two-bedroom end-terraced home, featuring a generously sized lounge, a separate dining room, a modern kitchen, and a stylish family bathroom. The property also boasts a private rear garden and is ideally situated in the sought-after area of Stirchley, Birmingham.

Cotteridge Road, Stirchley, Birmingham
Ground Floor

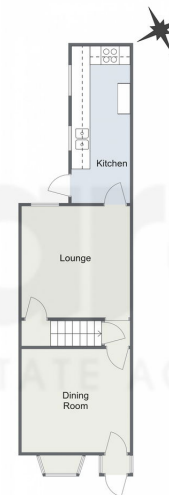

First Floor



Total Area Approx
72.0 Sq M
775.0 Sq Ft

For illustrative purposes only. Decorative finishes, fixtures & fittings do not represent the current state of the property. Measurements are approximate & not to scale. Floor plans made using RoomSketcher.

5/24, 11:30 AM

Energy performance certificate (EPC) - Find an energy certificate - GOV.UK

Energy performance certificate (EPC)																																			
2 Cotteridge Road BIRMINGHAM B15 2AC	Energy rating E	Valid until 7 October 2029	Certificate number 8811-7120-2119-7933-0902																																
Property type	end-terrace house																																		
Total floor area	72 square metres																																		
Rules on letting this property																																			
Properties can be let if they have an energy rating from A to E.																																			
You can read guidance for landlords on the regulations and exemptions .																																			
https://www.gov.uk/guidance/renting-a-property-in-england-energy-efficiency-standards-landlord-guidance																																			
Energy rating and score																																			
This property's energy rating is E. It has the potential to be B.		The graph shows this property's current and potential energy rating.																																	
See how to improve this property's energy efficiency.		Properties get a rating from A (best) to G (worst) and a score. The better the rating and score, the lower your energy bills are likely to be.																																	
<table border="1"> <thead> <tr> <th>Score</th> <th>Energy rating</th> <th>Current</th> <th>Potential</th> </tr> </thead> <tbody> <tr> <td>92-100</td> <td>A</td> <td></td> <td></td> </tr> <tr> <td>81-91</td> <td>B</td> <td></td> <td></td> </tr> <tr> <td>69-80</td> <td>C</td> <td></td> <td></td> </tr> <tr> <td>55-68</td> <td>D</td> <td></td> <td></td> </tr> <tr> <td>39-54</td> <td>E</td> <td></td> <td></td> </tr> <tr> <td>21-38</td> <td>F</td> <td></td> <td></td> </tr> <tr> <td>1-20</td> <td>G</td> <td></td> <td></td> </tr> </tbody> </table>		Score	Energy rating	Current	Potential	92-100	A			81-91	B			69-80	C			55-68	D			39-54	E			21-38	F			1-20	G			For properties in England and Wales: the average energy rating is D the average energy score is 60	
Score	Energy rating	Current	Potential																																
92-100	A																																		
81-91	B																																		
69-80	C																																		
55-68	D																																		
39-54	E																																		
21-38	F																																		
1-20	G																																		

https://find-energy-certificate.service.gov.uk/energy-certificates/8811-7120-2119-7933-0902?print=true

1/4

For more information on this house or to arrange a viewing please call the office on:

0121 453 4349

Alternatively, you can scan the QR to view all of the details of this property online.

