



It's who
you move
with.

Church Lane, Norton, Worcester, WR5 2PS

Offers Over £550,000

🛏️ 4 🚿 2 🚻 2



The property welcomes you with a shared tarmac entrance leading to a block-paved driveway that can comfortably accommodate up to six cars. Set back from the road, it offers a wonderful sense of privacy, framed by mature trees and a neatly maintained lawn. At the end of the driveway, you'll find an integral garage, a side gate to the garden, and the front door.

Step inside to a bright and inviting hallway, thanks to a window that allows natural light to pour in. From here, you can access the cozy living room, the study, the kitchen-dining area, and a handy cloakroom. The staircase also leads you to the first floor.

The front reception room feels particularly welcoming with its south-facing bay window, bathing the space in sunlight. On colder days, the wood-burning stove nestled within the fireplace makes this the perfect spot to relax and unwind.

At the back of the house, the open-plan kitchen and dining area create a lovely heart of the home. With plenty of units, an electric oven, hob, and integrated fridge-freezer, the kitchen is well-equipped. The dining area, large enough for an eight-seater table, flows seamlessly into the conservatory through French doors, making it ideal for family meals or entertaining. Nearby, the utility room provides additional space for laundry, with a door leading directly to the garden.

The conservatory is a peaceful retreat, offering delightful views of the garden and easy access to the patio through French doors, perfect for a summer's day. A cozy study overlooks the side garden, making it the perfect home office or reading nook.

Upstairs, the spacious landing leads to four lovely bedrooms, the family bathroom, and access to the loft. The master bedroom, located at the front, is generously sized and includes an ensuite shower room with a powerful shower, WC, and washbasin. The second bedroom, also facing the front, offers plenty of space and a view of the garden. Bedrooms three and four are located at the rear, with one serving as a comfortable double and the other being ideal as a single bedroom or guest room, both offering views of the lush garden.



Church Lane, Norton

Ground Floor

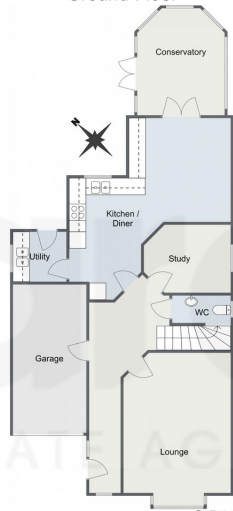

First Floor

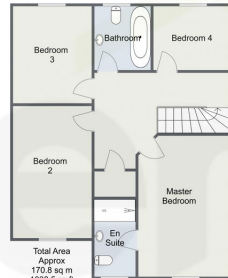

Total Area
Approx
170.8 sq m
1838.5 sq ft

For illustrative purposes only. Decorative finishes, fixtures & fittings do not represent the current state of the property. Measurements are approximate & not to scale. Floor Plans made using RoomSketcher.

- Integral Garage
- Study
- Kitchen Diner
- Village Location
- Well-Proportioned Bedrooms
- Family Home

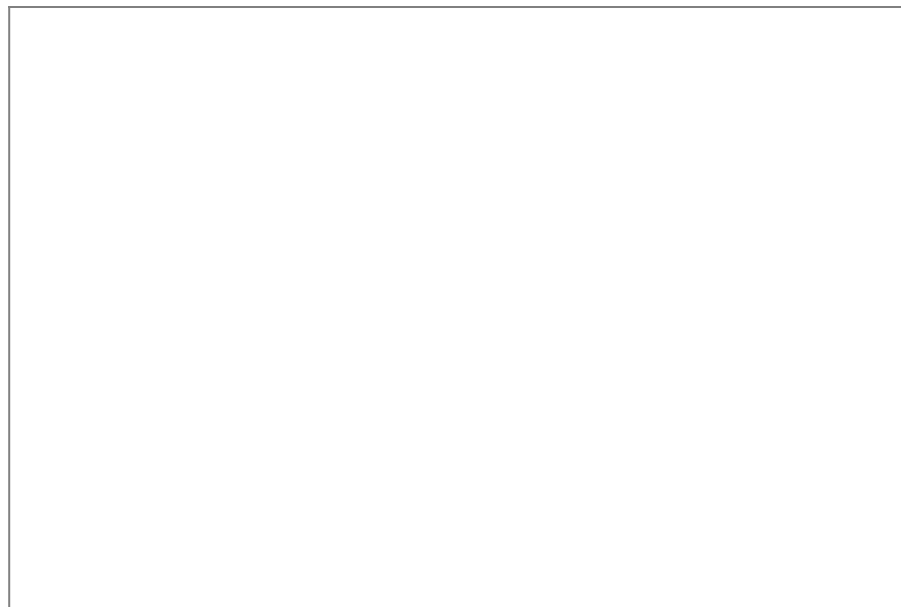

For more information on this house or to arrange a viewing please call the office on:

01905 958 290

Alternatively, you can scan the QR to view all of the details of this property online.

