





Ryde Park Road, Rednal, Birmingham, B45 8RJ

£225,000

3 1 1



- Three Bedrooms
- Open Plan Modern Kitchen
- Lounge/Diner
- Modern Family Bathroom
- Rear Garden
- Detached Double Garage
- No Upward Chain
- Close to Amenities





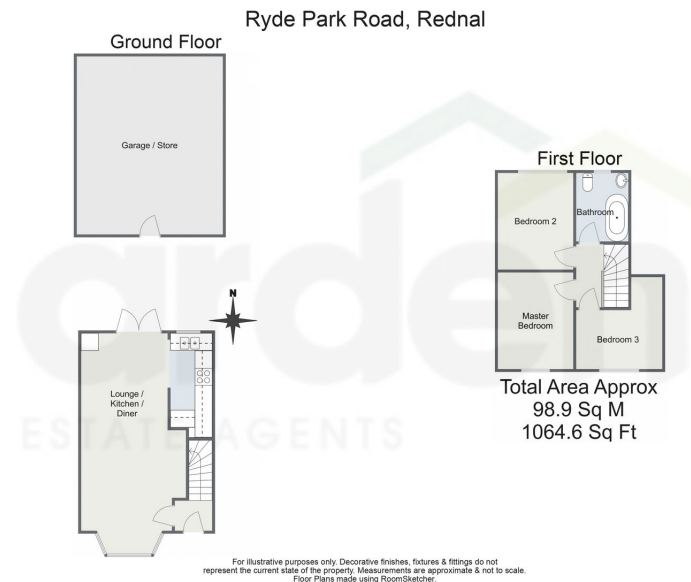

Introducing a beautifully refurbished three-bedroom mid-terraced home, offered with no upward chain. This stylish property features open-plan living on the ground floor, a sleek modern kitchen, a contemporary bathroom, and a spacious rear garden complete with a detached double garage. Ideally located in the sought-after area of Rednal, Birmingham.

83024\_243\_PM Energy performance certificate (EPC) - Find an energy certificate - GOV.UK

Energy performance certificate (EPC)	
218 RYDE PARK ROAD REDNAL BIRMINGHAM B15 8JU	Energy rating <b>D</b> Valid until: 28 July 2021 Certificate number: 0348-2191-9030-2429-5885
Property type	Mid-terrace house
Total floor area	67 square metres

**Rules on letting this property**

Properties can be let if they have an energy rating from A to E.

You can read [guidance for landlords on the regulations and exemptions](https://www.gov.uk/guidance/landlords-on-the-requirements-and-exemptions) (<https://www.gov.uk/guidance/landlords-on-the-requirements-and-exemptions>).

**Energy rating and score**

This property's energy rating is D. It has the potential to be B.

[See how to improve this property's energy efficiency.](#)

The graph shows this property's current and potential energy rating.

**Properties get a rating from A (best) to G (worst) and a score.** The better the rating and score, the lower your energy bills are likely to be.

For properties in England and Wales:  
the average energy rating is D  
the average energy score is 60

Score	Energy rating	Current	Potential
92-100	A		
81-91	B		
69-80	C		
55-68	D	41.8	
39-54	E		
21-38	F		
1-20	G		

For more information on this house or to arrange a viewing please call the office on:  
**0121 453 4349**

Alternatively, you can scan the QR to view all of the details of this property online.

