

Plymouth Road, Southcrest, Redditch B97 4NZ

Offers Over £330,000

🛏 3 🚿 1 🚗 2



- Extended End Terrace House
- Spacious Lounge
- Well Appointed Dining Kitchen
- Large Store Room
- Ample Driveway Parking
- Three Bedrooms
- Dining Room with Bi-Folding Doors
- Modern Bathroom and Guest WC
- Wonderful Rear Gardens
- Great Location for Town Centre Access

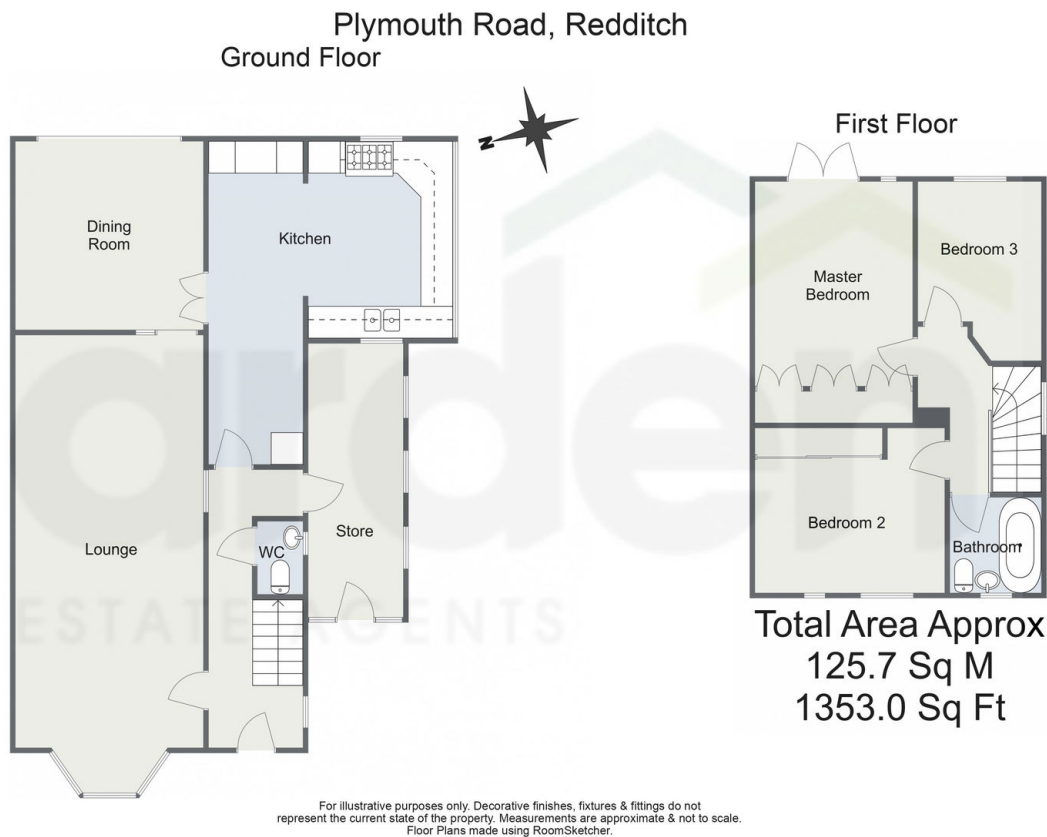

This extended and beautifully presented three-bedroom end of terrace property, located in Southcrest, offers an ideal blend of convenience and comfort. Situated within walking distance to Pitcheroak Woods and the Redditch Town Centre, this home provides well-proportioned accommodation, a wonderful rear garden and driveway for ample parking.