

Blaythorn Avenue, Solihull, B92 8TS

Offers Over £390,000

🛏 4 🚿 2 🚗 2



- Four Bedrooms
- Kitchen
- Off Road Parking
- Conservatory
- 1250 SQFT
- Master Bedroom With Fitted Wardrobes & Ensuite
- Utility
- Garage
- West Facing Garden
- Full Colour CCTV Recording System

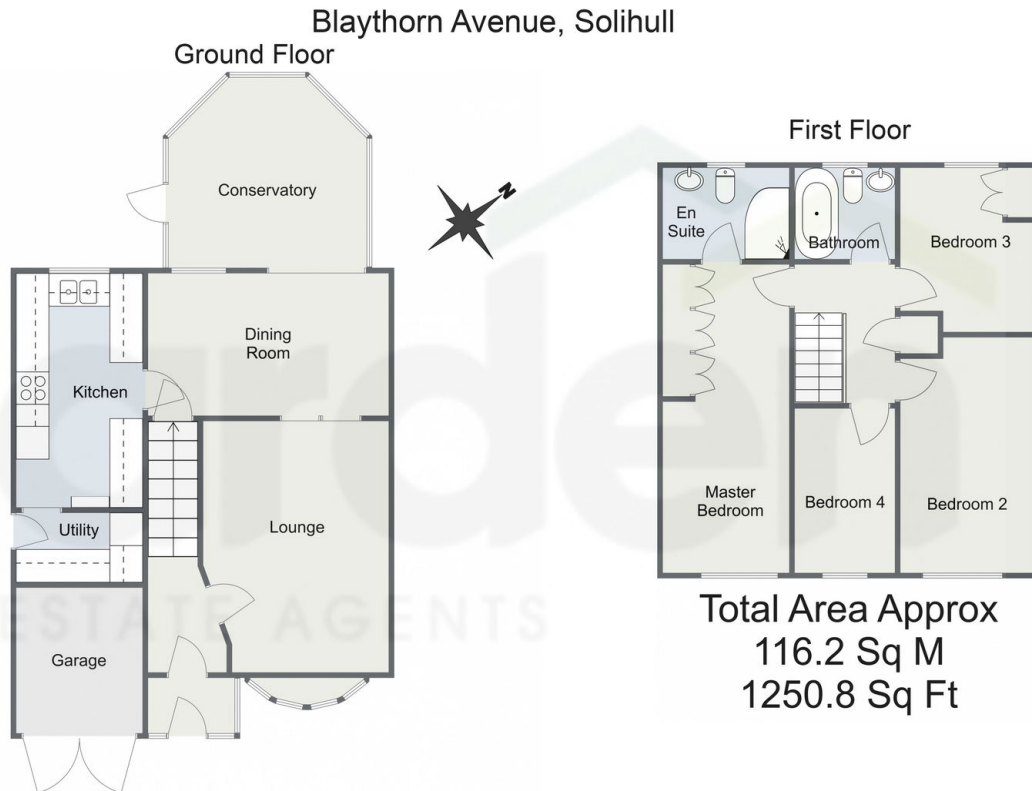

For illustrative purposes only. Decorative finishes, fixtures & fittings do not represent the current state of the property. Measurements are approximate & not to scale. Floor Plans made using RoomSketcher.

Welcome to this spacious and inviting 4-bedroom detached property nestled in the heart of Solihull. As you approach the property, you'll be greeted by a generous driveway, providing ample space for multiple cars, along with a convenient garage for additional parking or storage.