



The Oaklands, Droitwich, WR9 8AD

Offers Over £400,000

🛏️ 4 🚿 2 🚗 1



This property is ideal for growing families or those looking for more space in a sought-after location. With four bedrooms, two bathrooms (including an en-suite), a large kitchen/diner, and a spacious lounge, this home offers both comfort and functionality. Its proximity to local amenities and its modern features make it a fantastic opportunity to own a contemporary family home in Droitwich.

On the ground floor, the property welcomes you into the hallway with access to the w/c, lounge and kitchen diner. The lounge is bright and spacious, perfect for both relaxation and entertaining. Adjacent to the lounge is the large, open-plan kitchen/diner, which offers ample space for family meals and gatherings. The kitchen is the heart of the home, having been updated to a high specification. The gloss cabinets perfectly contrast the worktops and the downlights add to the overall ambience. There is an integrated induction hob, extractor fan and double oven. The extended worktop acts as a breakfast bar with space for two stools is perfect for informal dining or socializing with guests while cooking. The dining area provides easy access to the rear garden through double doors, creating an ideal indoor-outdoor flow. The ground floor also features a convenient utility room, offering additional storage and laundry facilities, with direct access to the garden. A separate WC is located near the entrance, perfect for guests.

The first floor features four generously sized bedrooms. The master bedroom is equipped with its own en-suite shower room, providing privacy and convenience. The en-suite has conveniently been designed as a wet room. The other three bedrooms are spacious, offering flexible use as children's rooms, guest rooms, or home offices. The family bathroom is located centrally and includes a bath with an overhead shower, ensuring comfort for the entire household.

Outside the garden is perfect for enjoying warmer days with a patio area perfect for al-fresco dining and the rest being laid to lawn. Additionally, the property benefits from an integrated garage providing additional storage.

Location: Droitwich Spa is a charming town brimming with history, renowned for its brine and salt production. The town benefits from a Waitrose store and a wide range of local amenities, including an



The Oaklands, Droitwich
Ground Floor

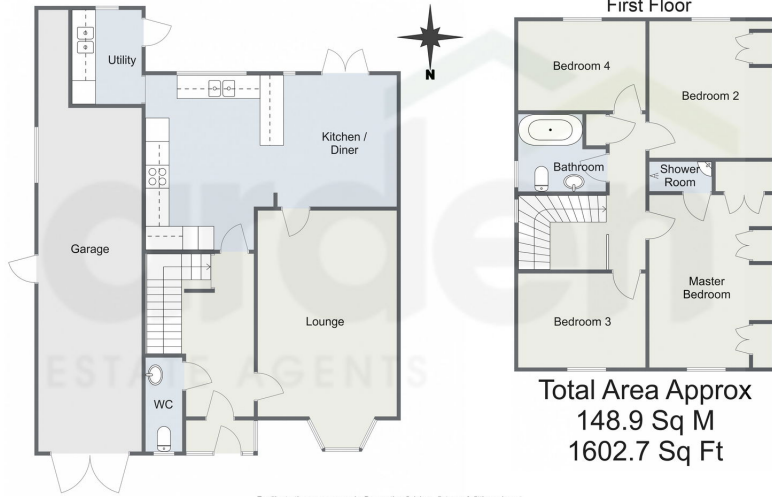

Total Area Approx
148.9 Sq M
1602.7 Sq Ft

For illustrative purposes only. Decorative finishes, fixtures & fittings do not represent the current state of the property. Measurements are approximate & not to scale. Floor Plans made using RoomSketcher.

- Integral Garage
- Updated Kitchen Diner
- Downstairs Toilet
- Utility
- Private Rear Garden
- Neutrally Decorated

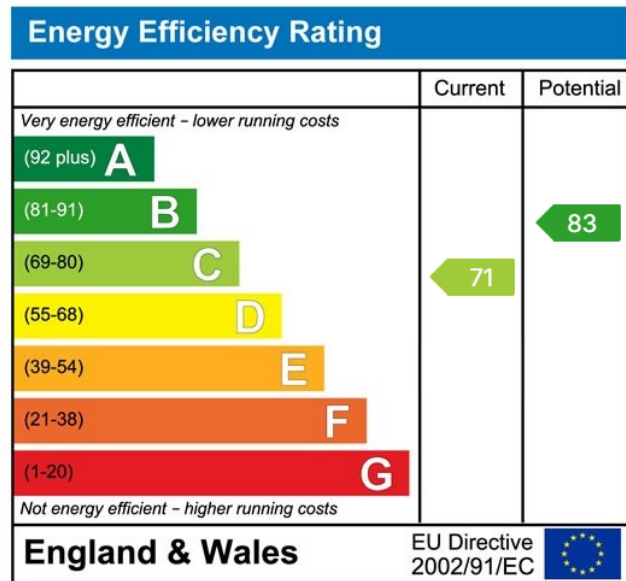

For more information on this house or to arrange a viewing please call the office on:

01905 958 290

Alternatively, you can scan the QR to view all of the details of this property online.

