

Cheshire Avenue, Shirley, Solihull, B90 2LJ

£350,000

3 1 1



- Three Bedrooms
- Lounge With Feature Fire Place
- Off Road Parking
- Delightful Rear Garden
- Modern Family Bathroom
- Modern Kitchen/Diner
- Detached Garage/Workshop
- Sought After Location

Cheshire Avenue, Shirley
Ground Floor

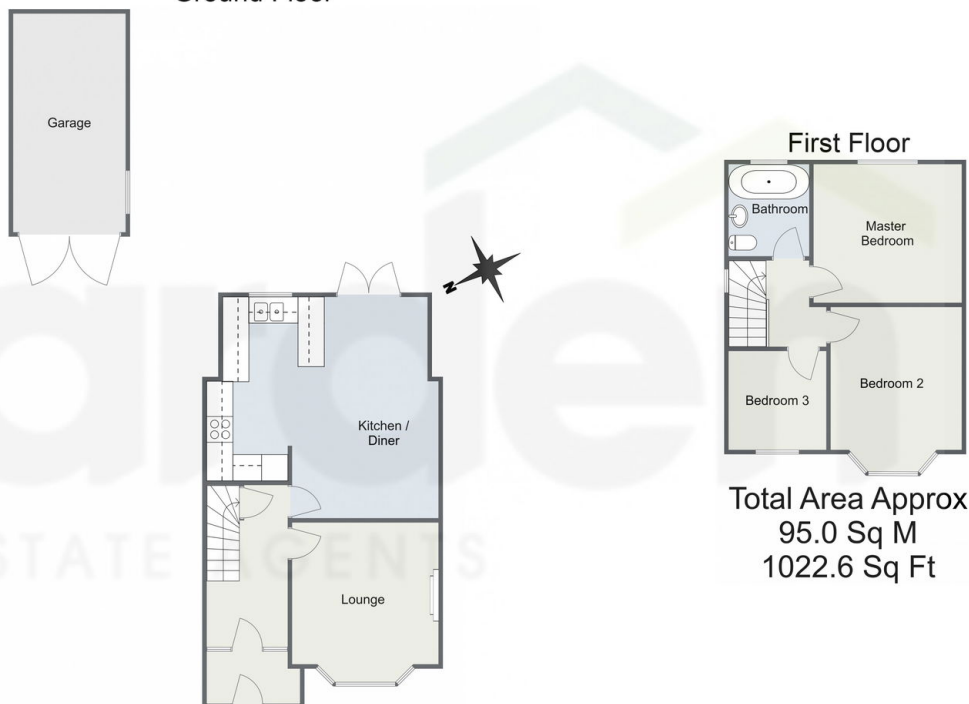

Total Area Approx
95.0 Sq M
1022.6 Sq Ft

For illustrative purposes only. Decorative finishes, fixtures & fittings do not represent the current state of the property. Measurements are approximate & not to scale. Floor Plans made using RoomSketcher.

A beautifully presented and particularly well maintained three bedroom semi detached property offered with a modern kitchen/diner, lounge, refurbished family bathroom, detached rear garage/workshop, delightful rear garden and situated in the sought after location of Shirley, Solihull.