



ADT

Yale

For Sale
arden
EST. 1999

arden
ESTATE AGENTS

It's who
you move
with.

Green Lane, Kings Norton, Birmingham, B38 9DW

£280,000

3 2 1



- Three Bedrooms
- Spacious Lounge
- Light and Airy Kitchen / Diner
- Downstairs WC
- Family Bathroom
- En-suite to Master Bedroom
- Rear Garden
- Off Road Parking with Electrical Charging Point



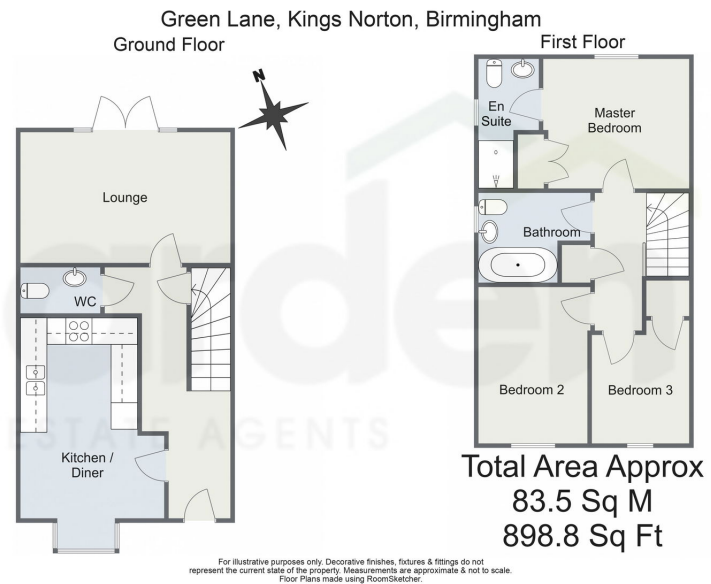

Introducing this beautifully maintained three-bedroom semi-detached home, featuring a spacious lounge, modern open-plan kitchen/diner, convenient downstairs WC, en-suite to the master bedroom, contemporary family bathroom, generously sized rear garden, and off-road parking. Ideally situated in the sought-after area of Kings Norton, Birmingham.

83024_133 PM Energy performance certificate (EPC) - Find an energy certificate - GOV.UK

Energy performance certificate (EPC)		
12, Green Lane BIRMINGHAM B38 8DQ	Energy rating B	Valid until 12 September 2029
		Certificate number 8231-7631-6998-9627-6996
Property type	Semi-detached house	
Total floor area	85 square metres	
Rules on letting this property		
Properties can be let if they have an energy rating from A to E.		
You can read guidance for landlords on the regulations and exemptions (https://www.gov.uk/guidance/landlords-on-the-requirements-and-exemptions).		
Energy rating and score		
The graph shows this property's current and potential energy rating.		
This property's energy rating is B. It has the potential to be A.		
Properties get a rating from A (best) to G (worst) and a score. The better the rating and score, the lower your energy bills are likely to be.		
For properties in England and Wales: the average energy rating is D the average energy score is 60		
Score	Energy rating	Current Potential
80+	A	85+
69-79	B	70+
55-68	C	55+
49-54	D	40+
39-48	E	35+
29-38	F	20+
13-28	G	10+

For more information on this house or to arrange a viewing please call the office on:
0121 453 4349

Alternatively, you can scan the QR to view all of the details of this property online.

