



# Rushock Close, Woodrow, Redditch B98 7UQ

£150,000

🛏️ 3 🚿 1 🚪 1



- Deceptively Spacious Mid Terrace
- Kitchen/ Diner
- Bathroom & Guest WC
- No Upward Chain
- Three Bedrooms
- Spacious Lounge
- Low Maintenance Rear Garden
- Ample External Storage



A deceptively spacious three bedroom mid terrace property, being sold with no upward chain. The property offers neatly presented accommodation and a low maintenance rear garden, and is situated in Woodrow.

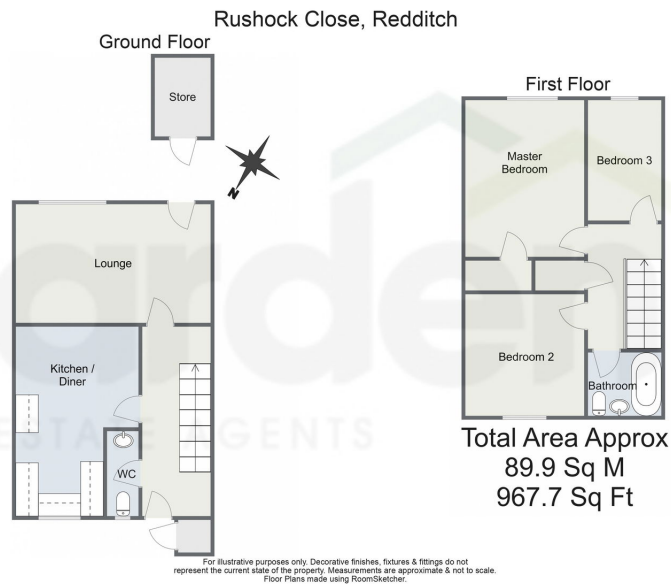

**Energy performance certificate (EPC)**

89, Rushock Close REDDITCH B98 7JG	Energy rating <b>C</b>	Valid until: 17 September 2025
		Certificate number: 0536-2896-7115-9195-0495

Property type: Mid-terrace house  
Total floor area: 85 square metres

**Rules on letting this property**

Properties can be let if they have an energy rating from A to E.

You can read [guidance for landlords on the regulations and exemptions](https://www.gov.uk/guidance/domestic-private-rented-property-minimum-energy-efficiency-standard-landlord-guidance) (<https://www.gov.uk/guidance/domestic-private-rented-property-minimum-energy-efficiency-standard-landlord-guidance>).

**Energy rating and score**

The graph shows this property's current and potential energy rating.

This property's energy rating is C. It has the potential to be B.

[See how to improve this property's energy efficiency.](#)

Score	Energy rating	Current	Potential
92+	A		
81-91	B		
69-80	C	← 59 C	→ 81 B
55-68	D		
39-54	E		
21-38	F		
1-20	G		

For properties in England and Wales:  
the average energy rating is D  
the average energy score is 60

**Properties get a rating from A (best) to G (worst) and a score. The better the rating and score, the lower your energy bills are likely to be.**

For more information on this house or to arrange a viewing please call the office on:

**01527 540 654**

Alternatively, you can scan the QR to view all of the details of this property online.

